

LEGO

Belville™

7586

1/5



Lights up

1

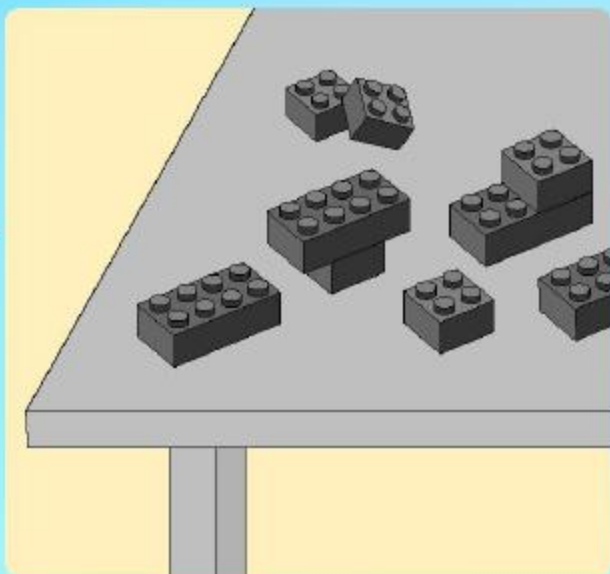

2

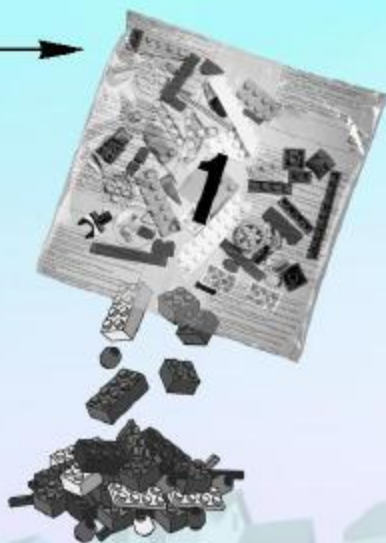

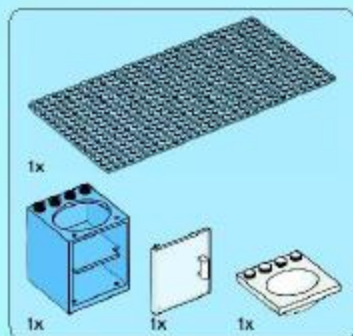

1

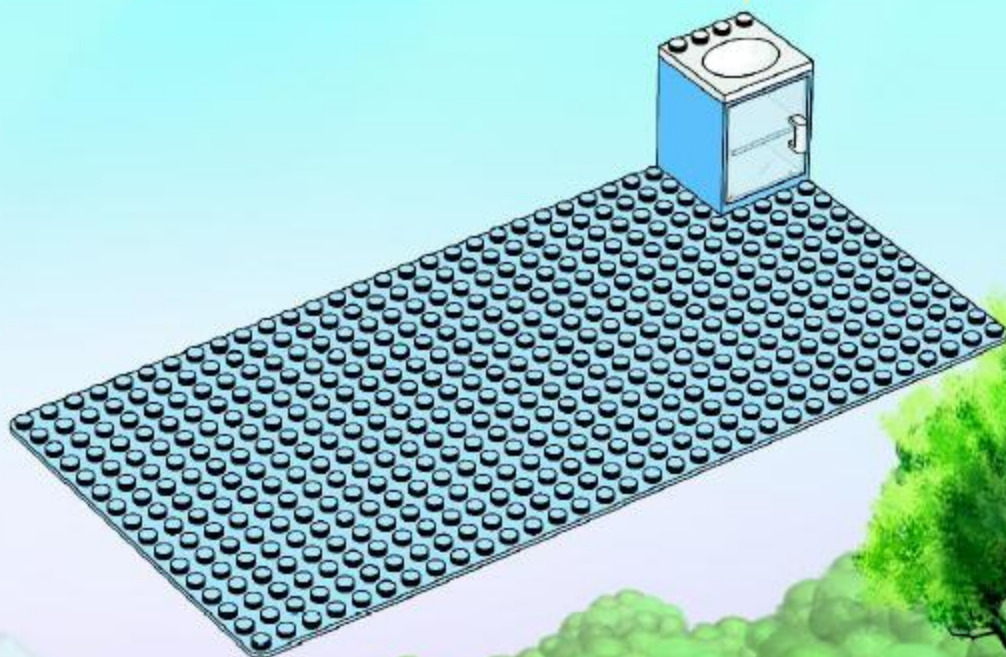
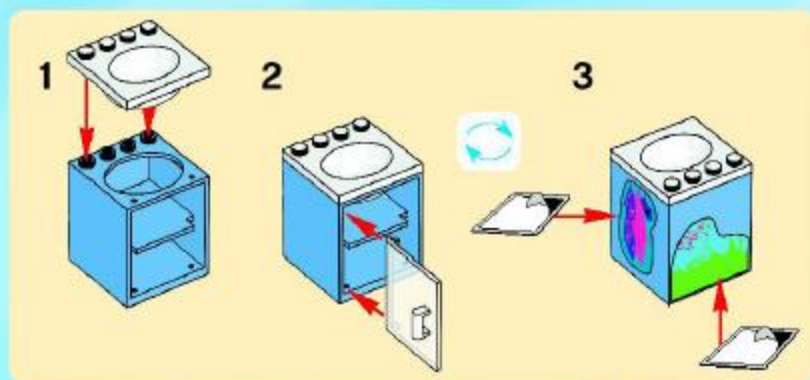

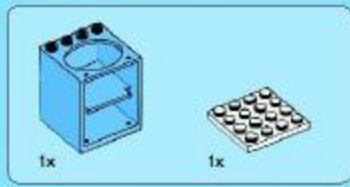

2

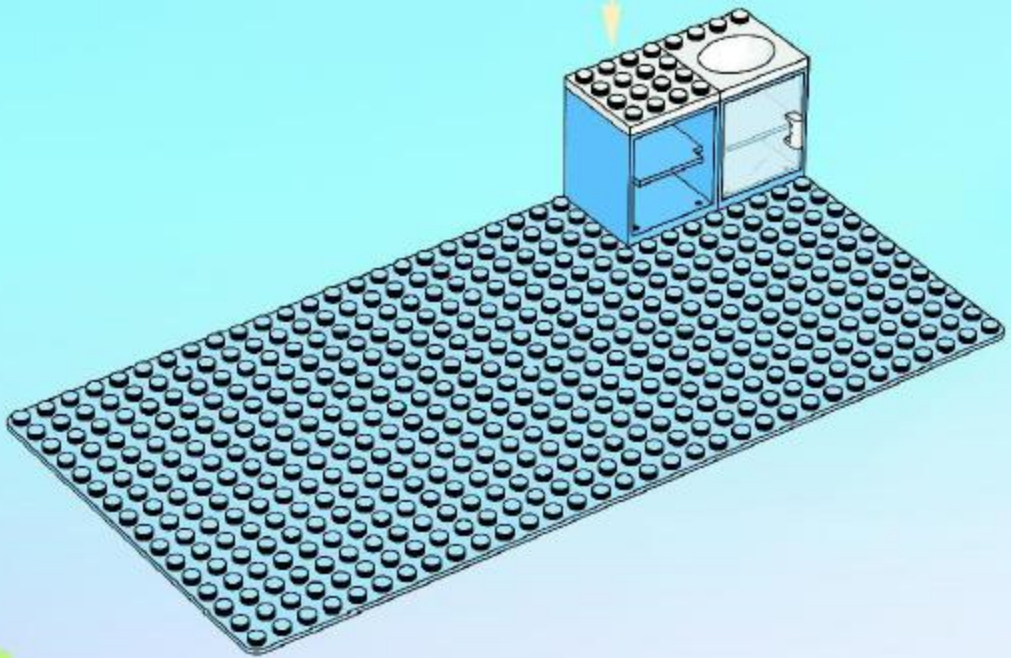
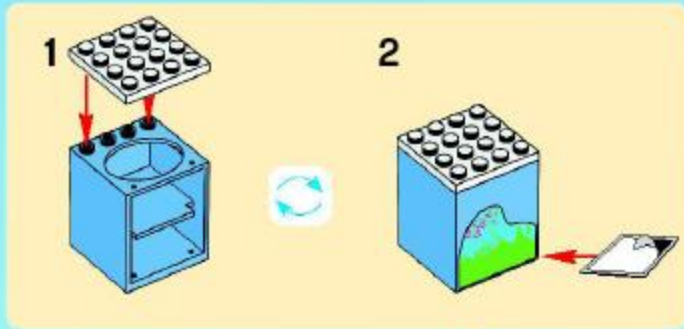

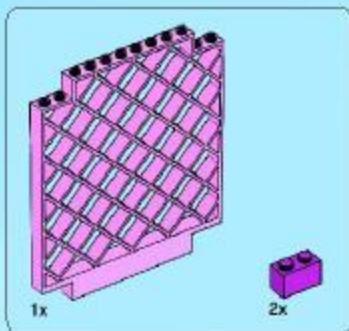

3

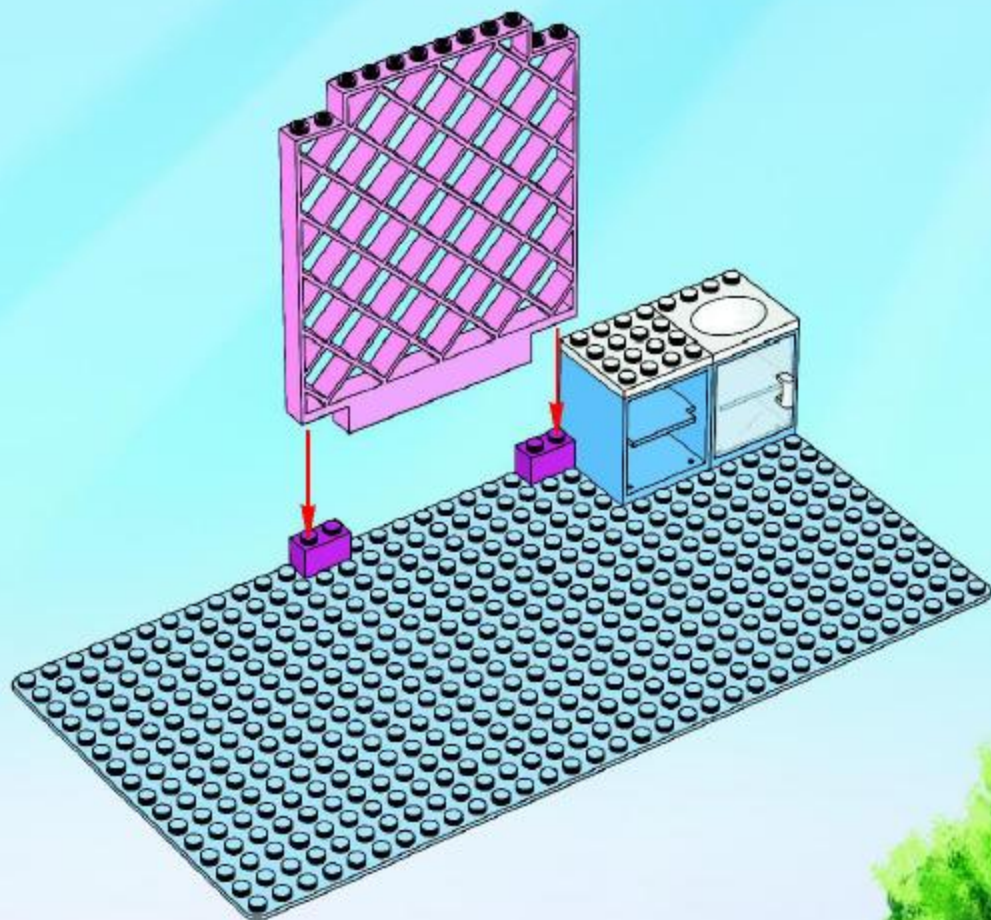

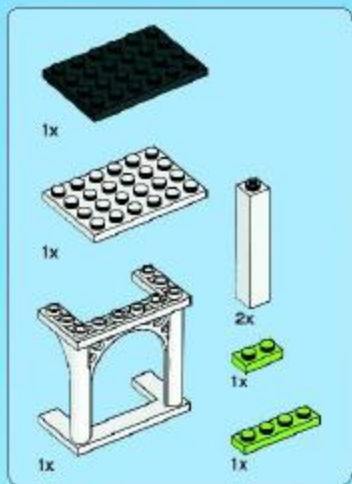

4

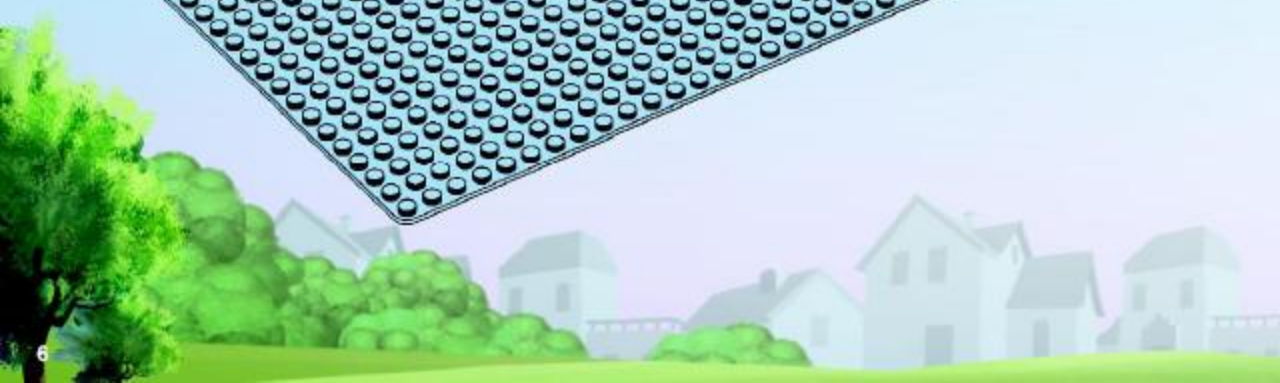
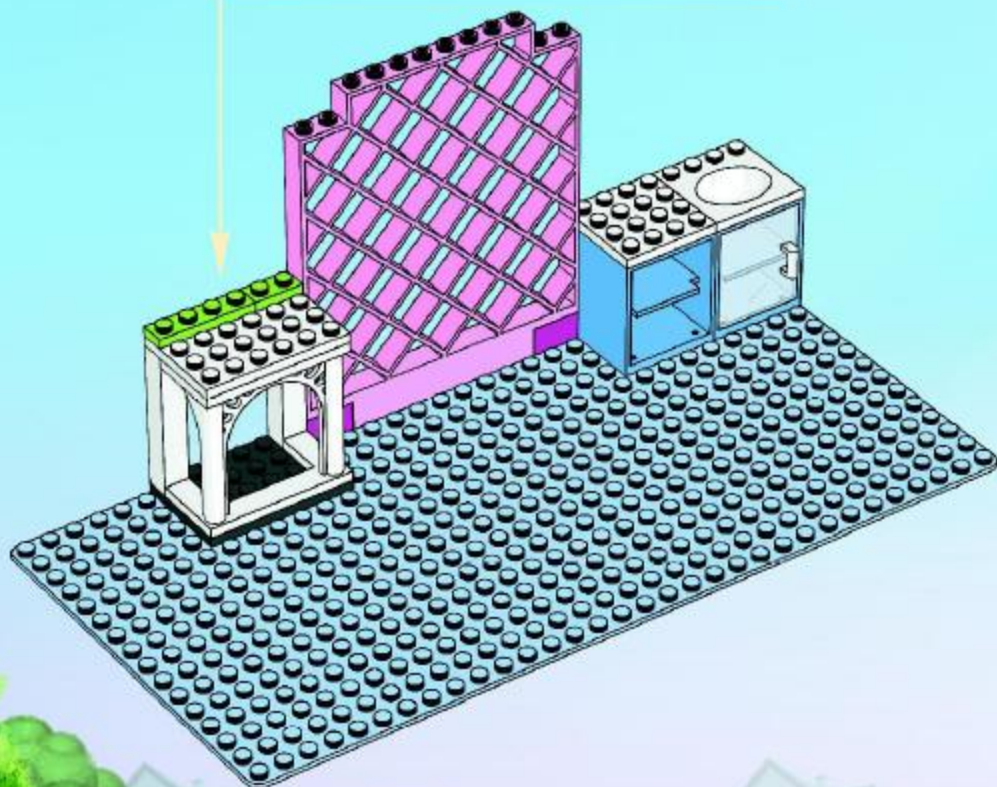
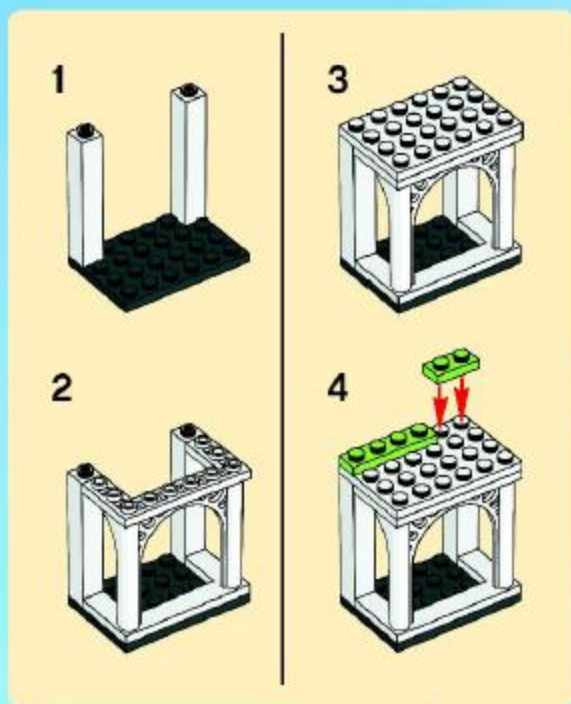

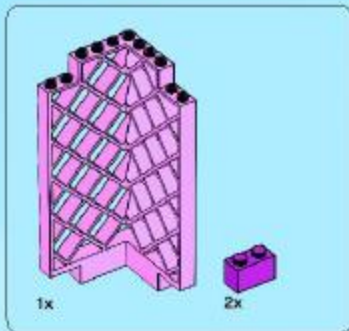

5

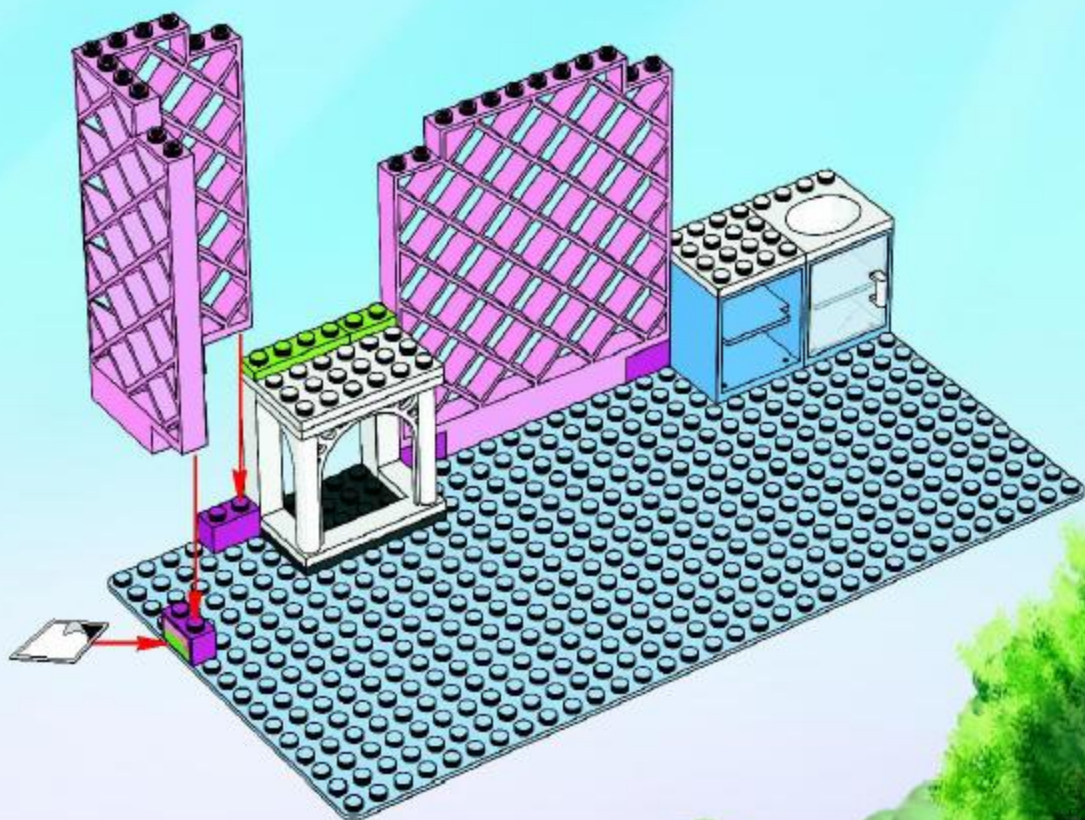



6

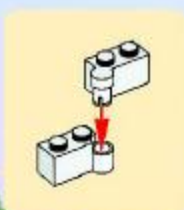
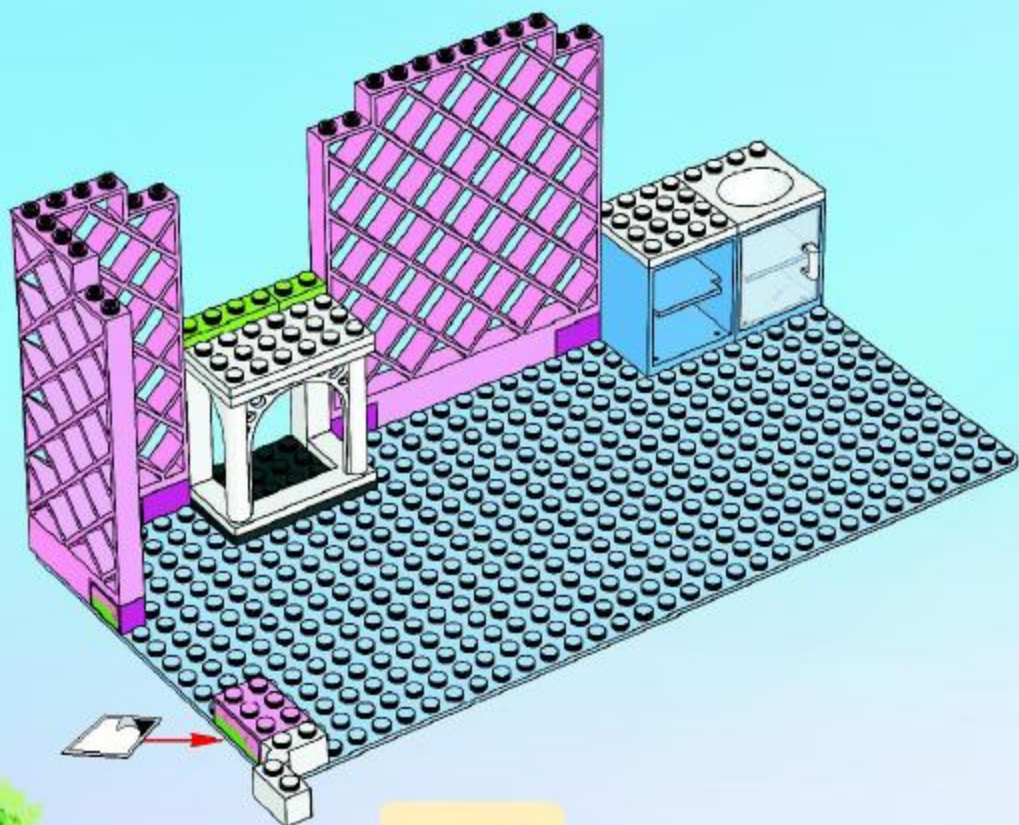

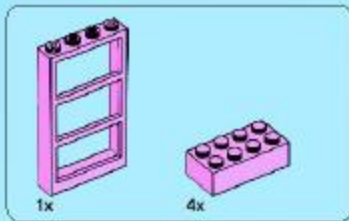

7

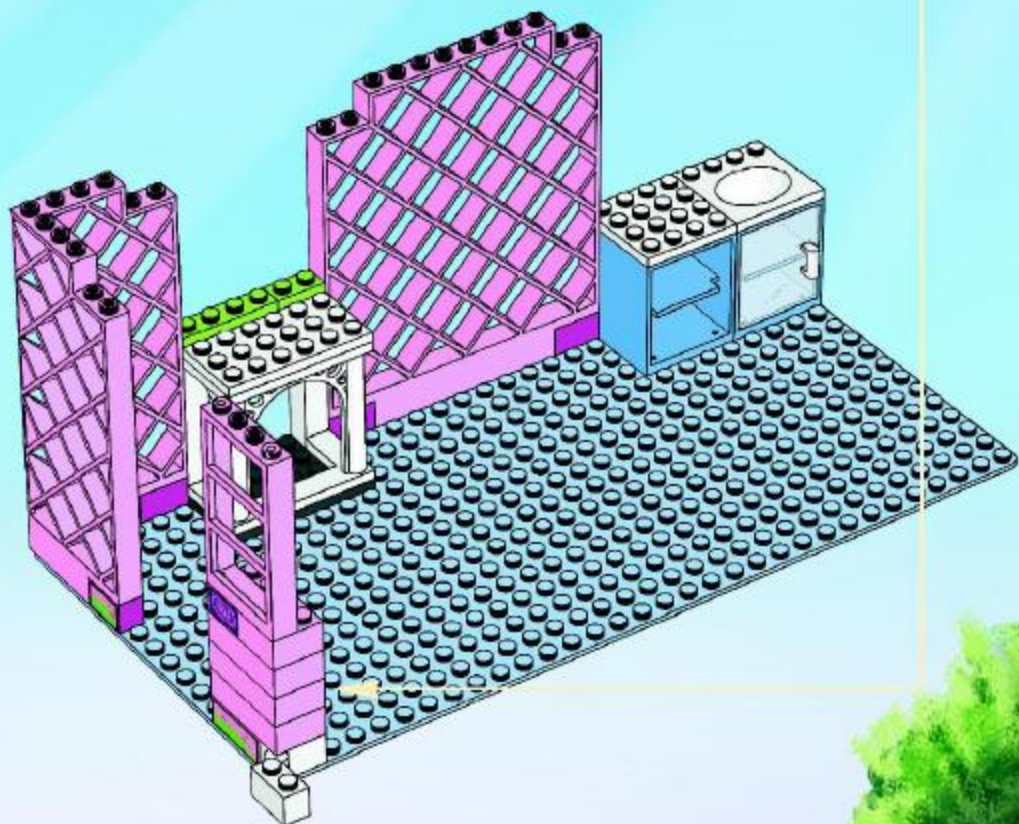
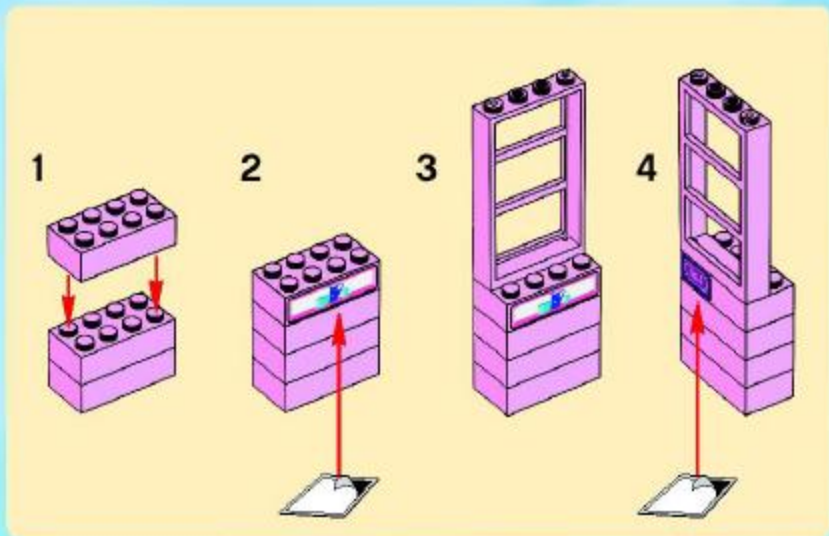



8

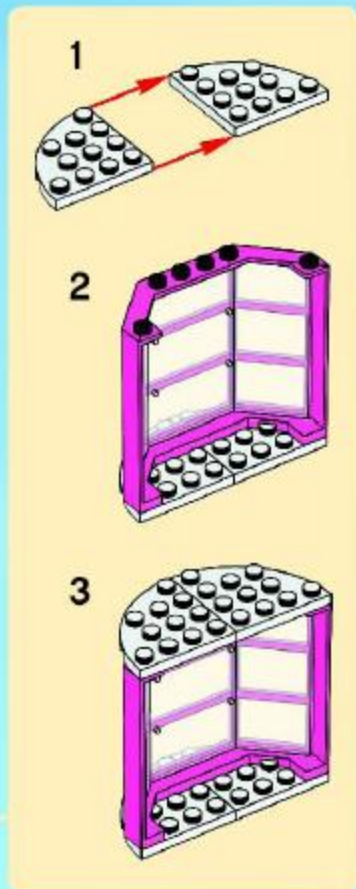
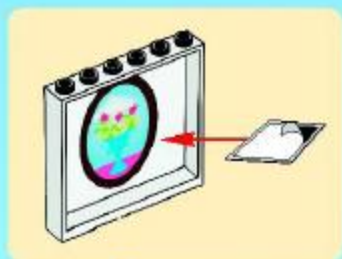

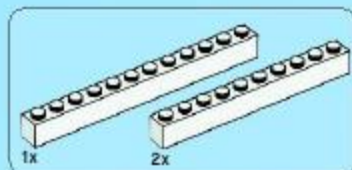

9





10

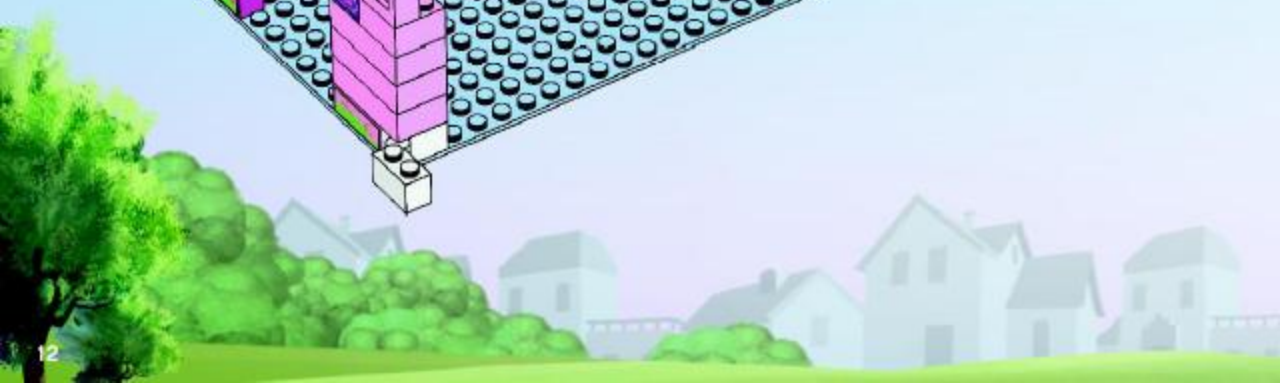
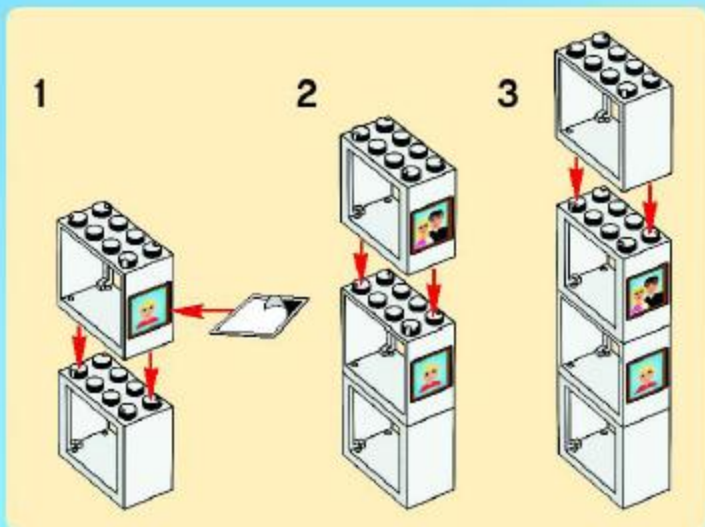

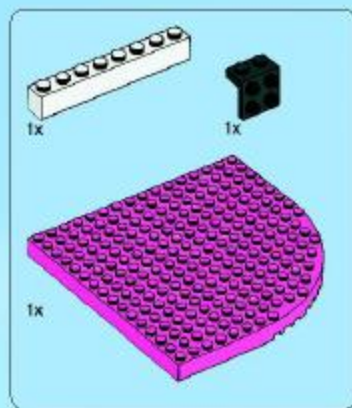

11

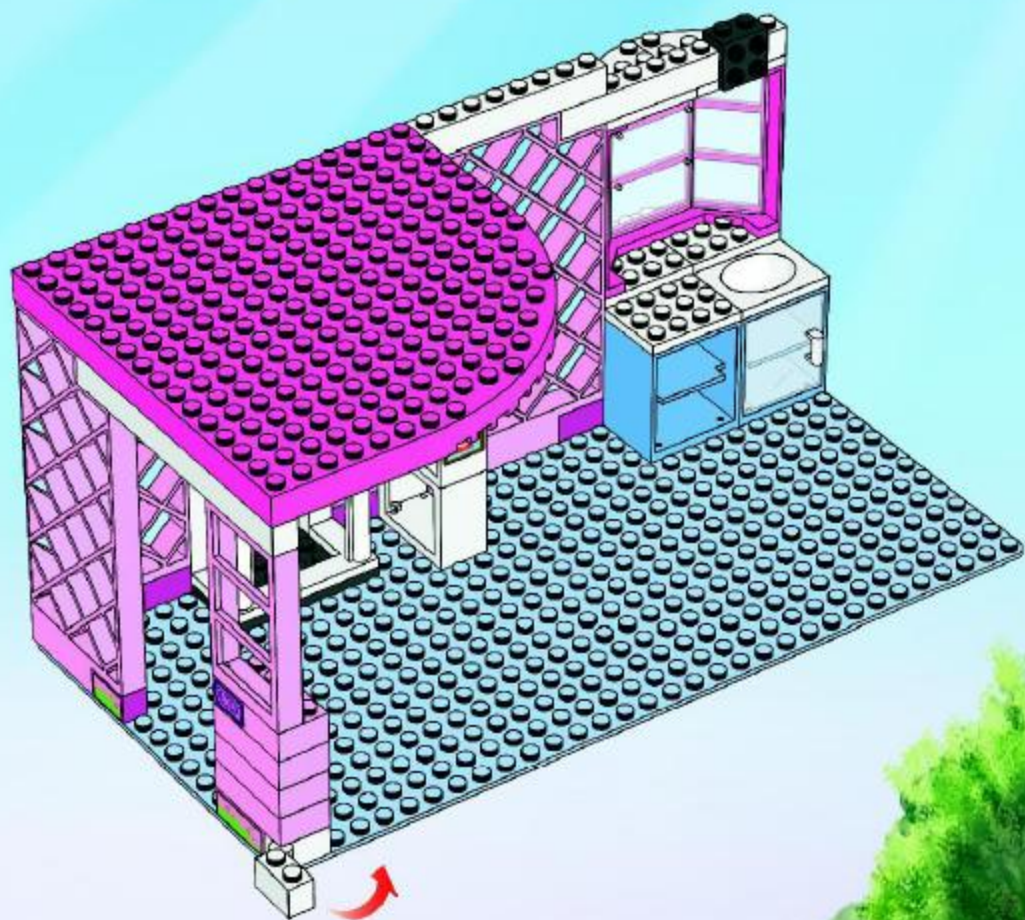



12



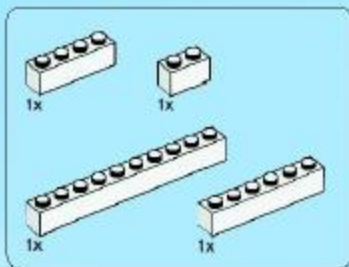

13

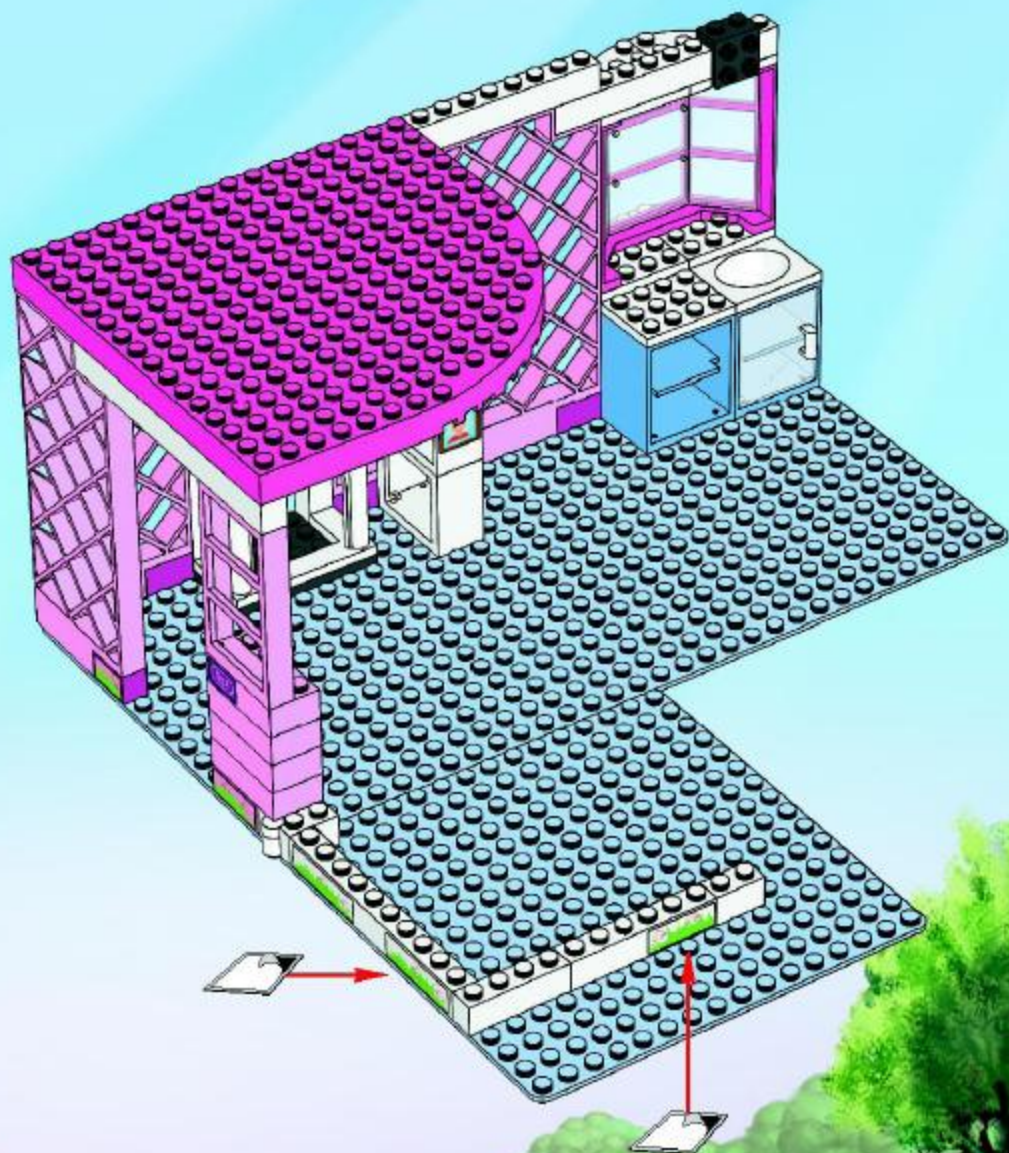

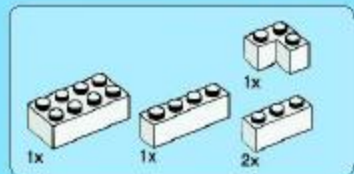

14

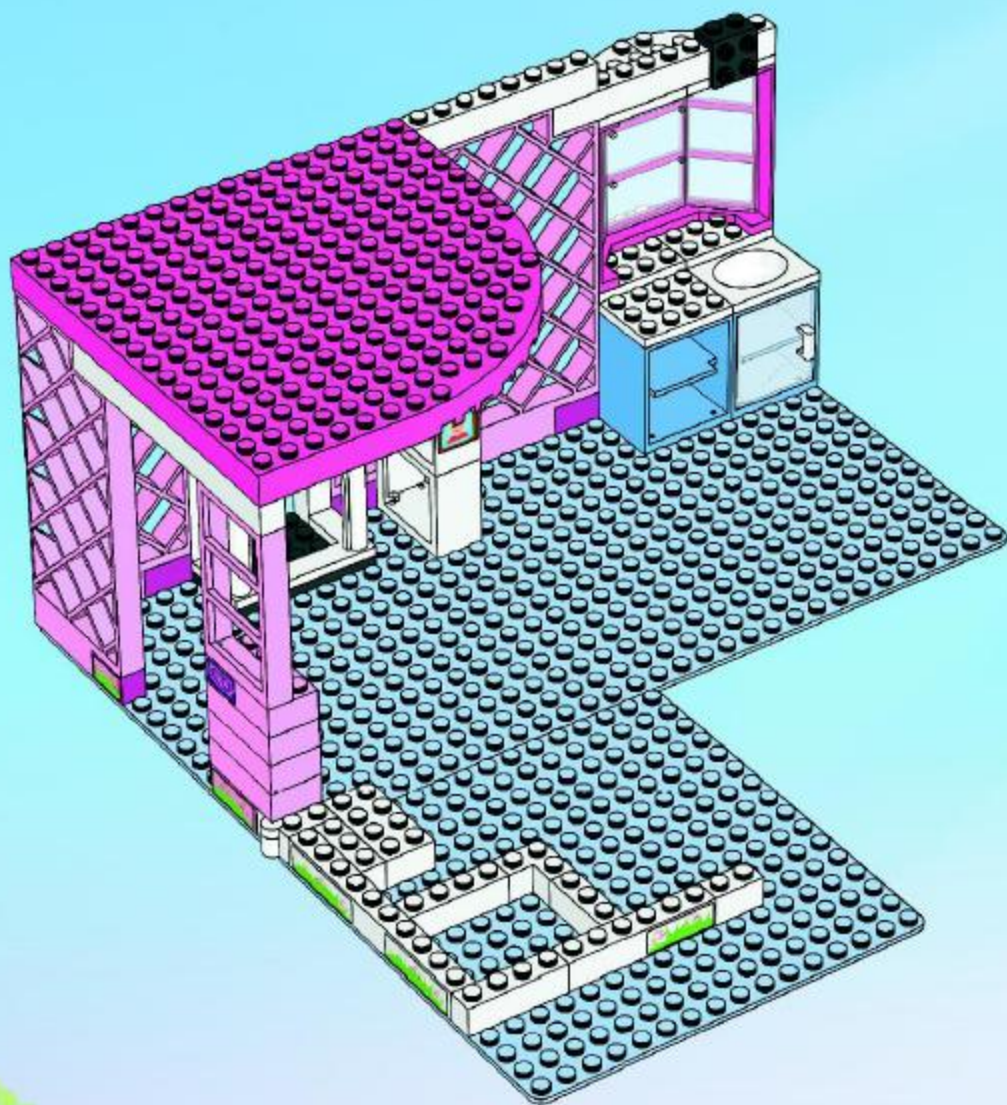



Belville™

7586

2/5



Lights up

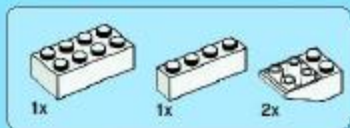

15

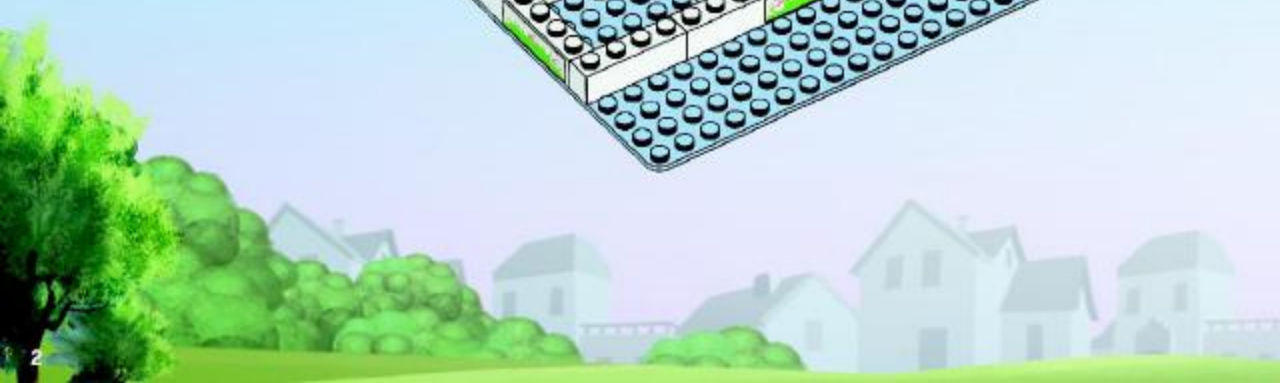

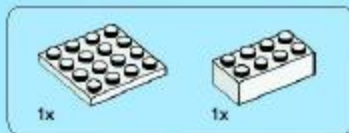

16



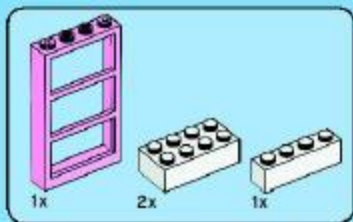

17

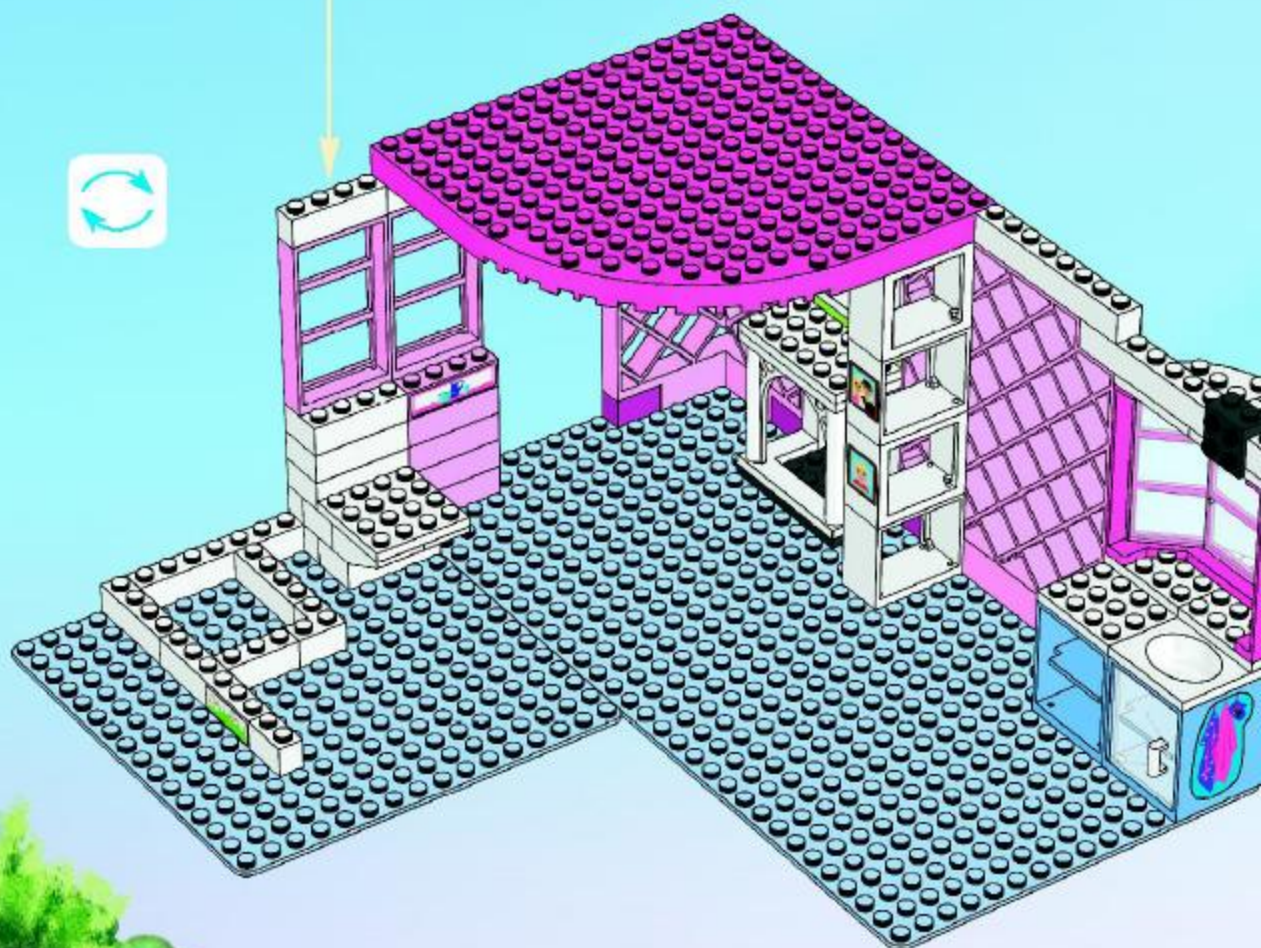
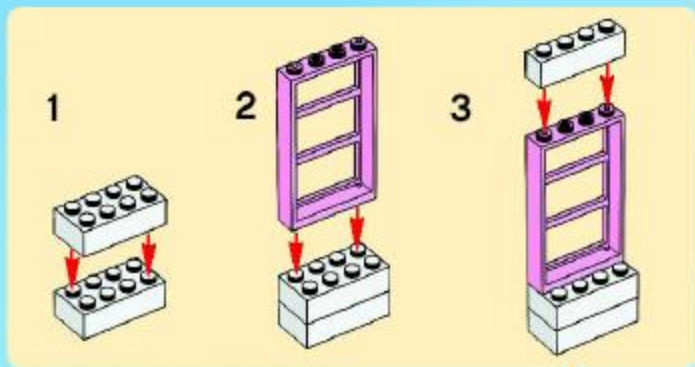

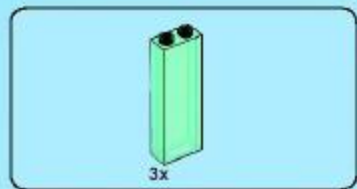

18

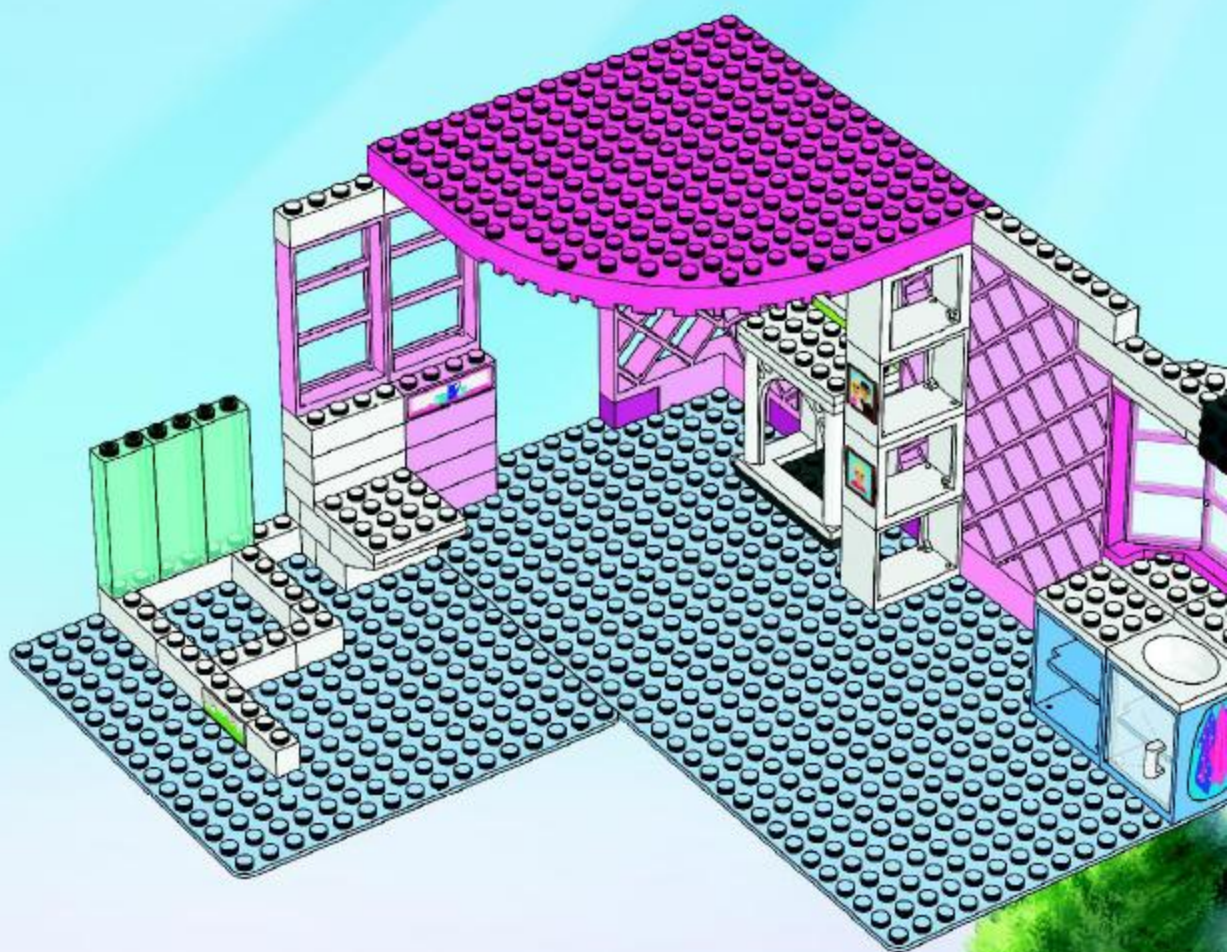

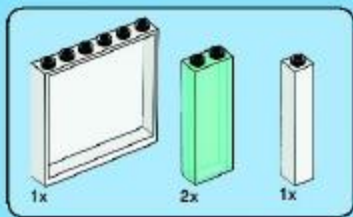

19

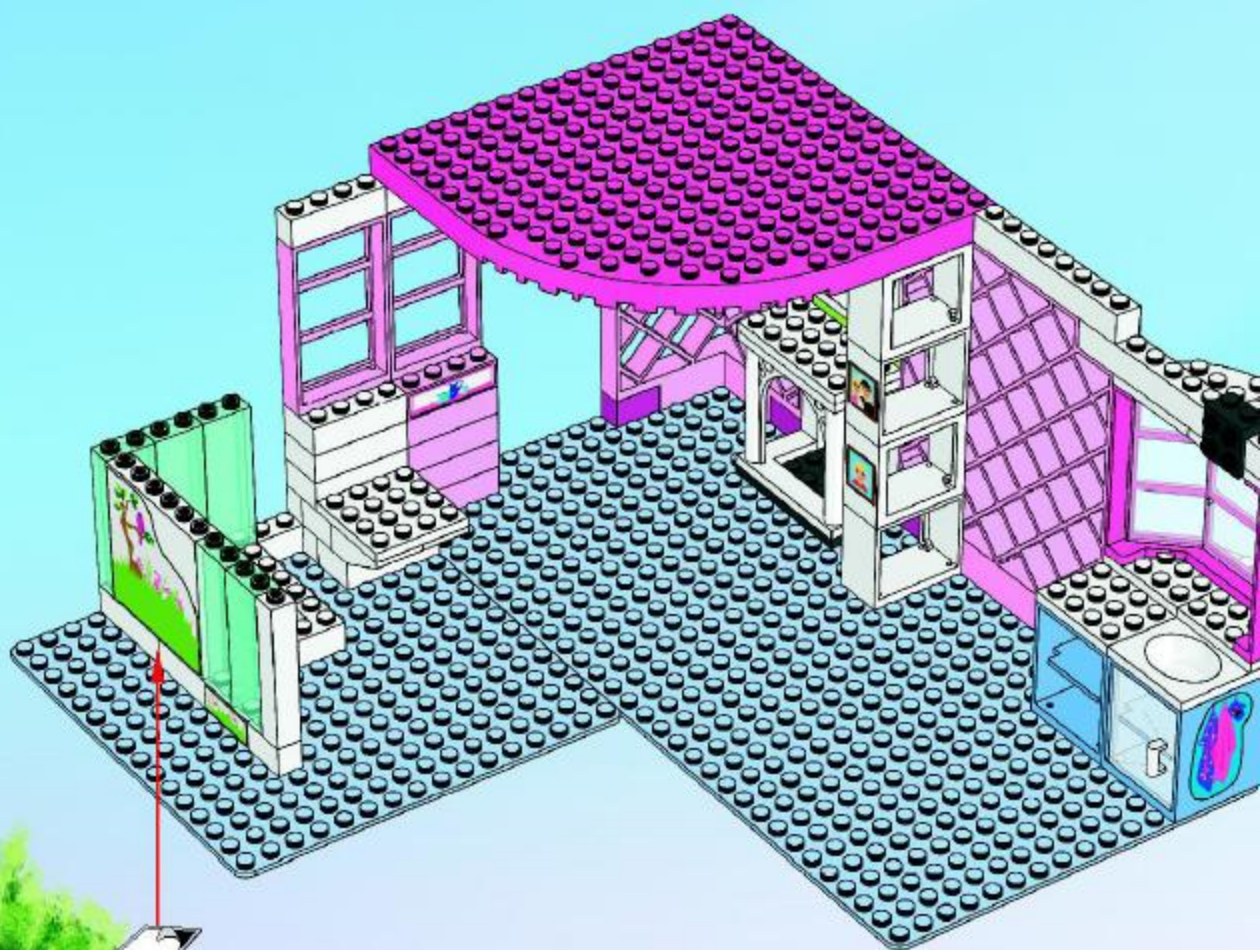

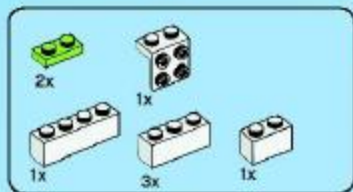

20

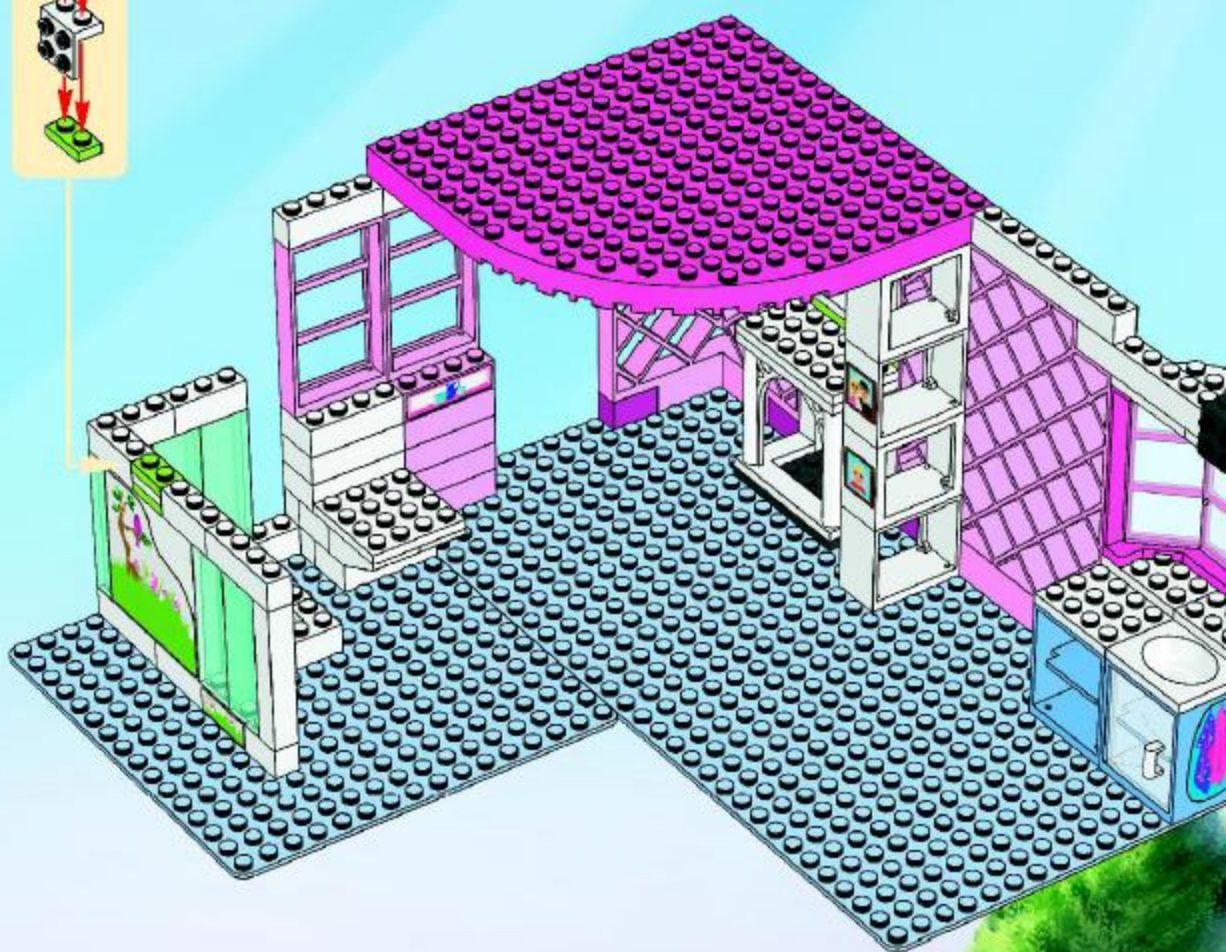

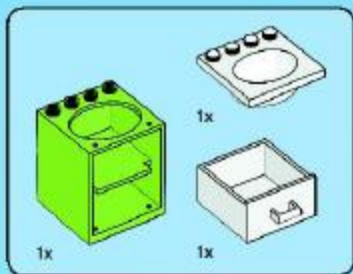

21

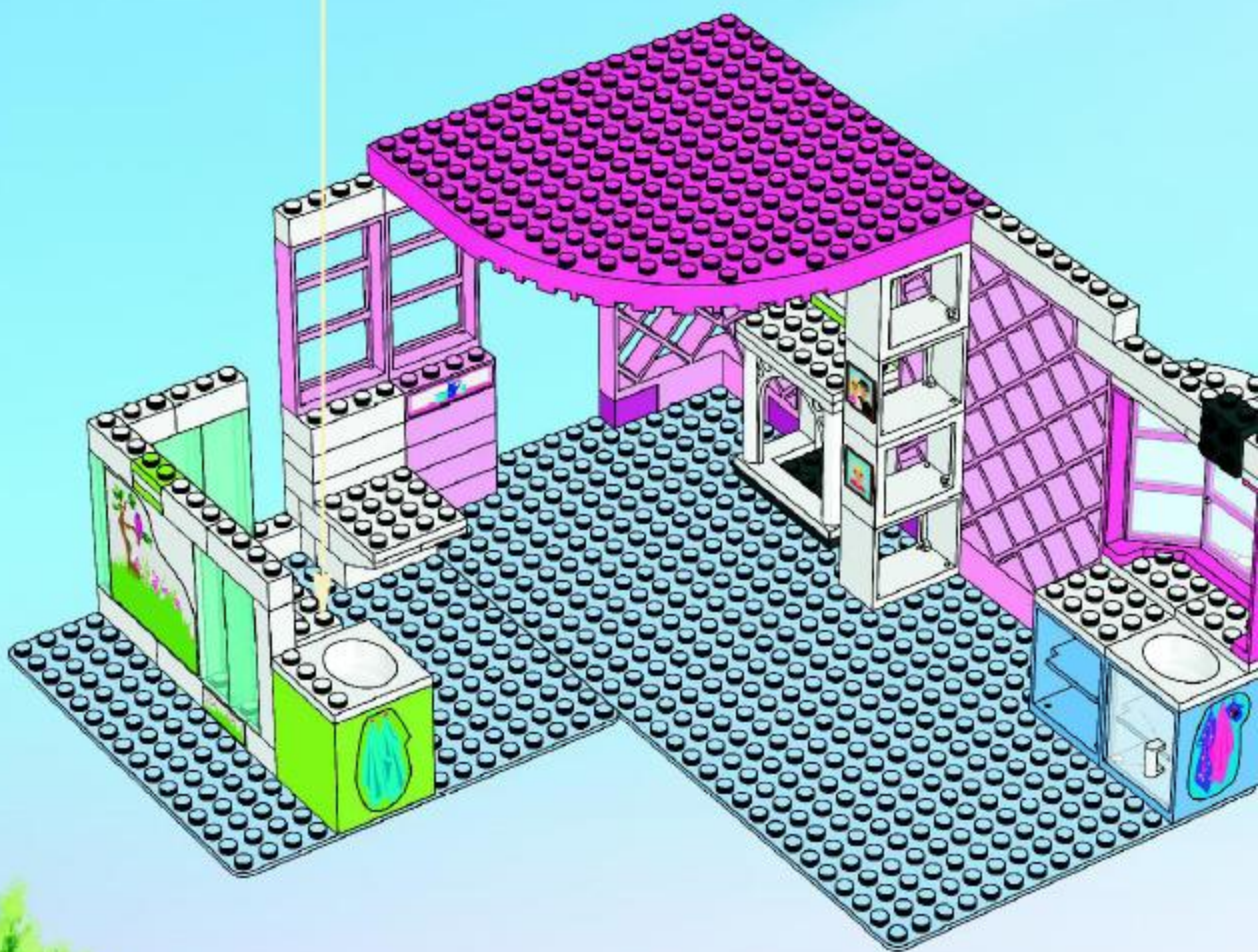

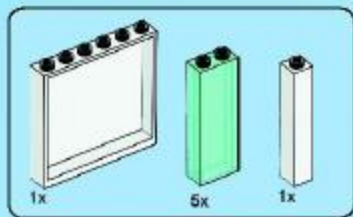

22

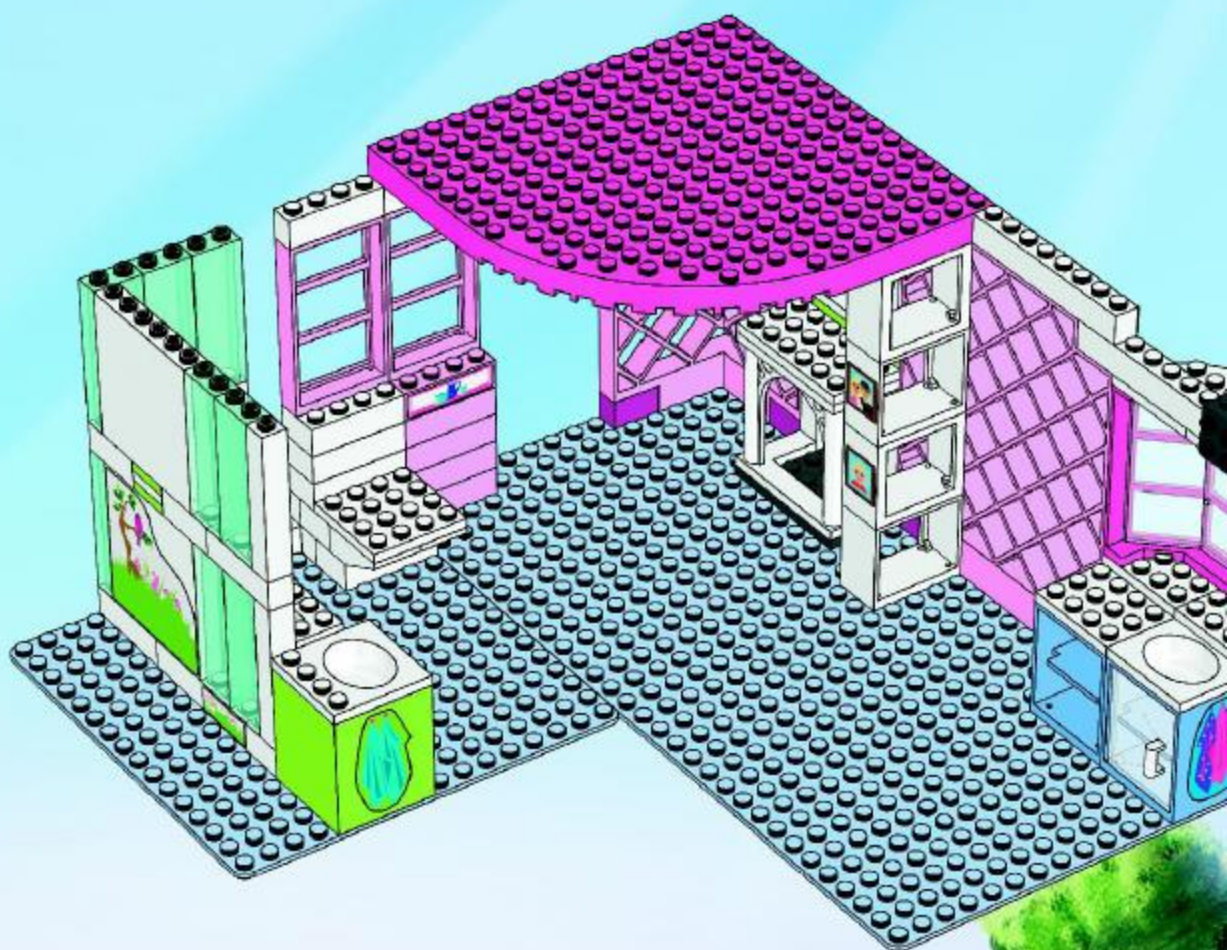

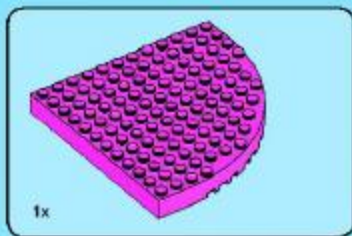

23

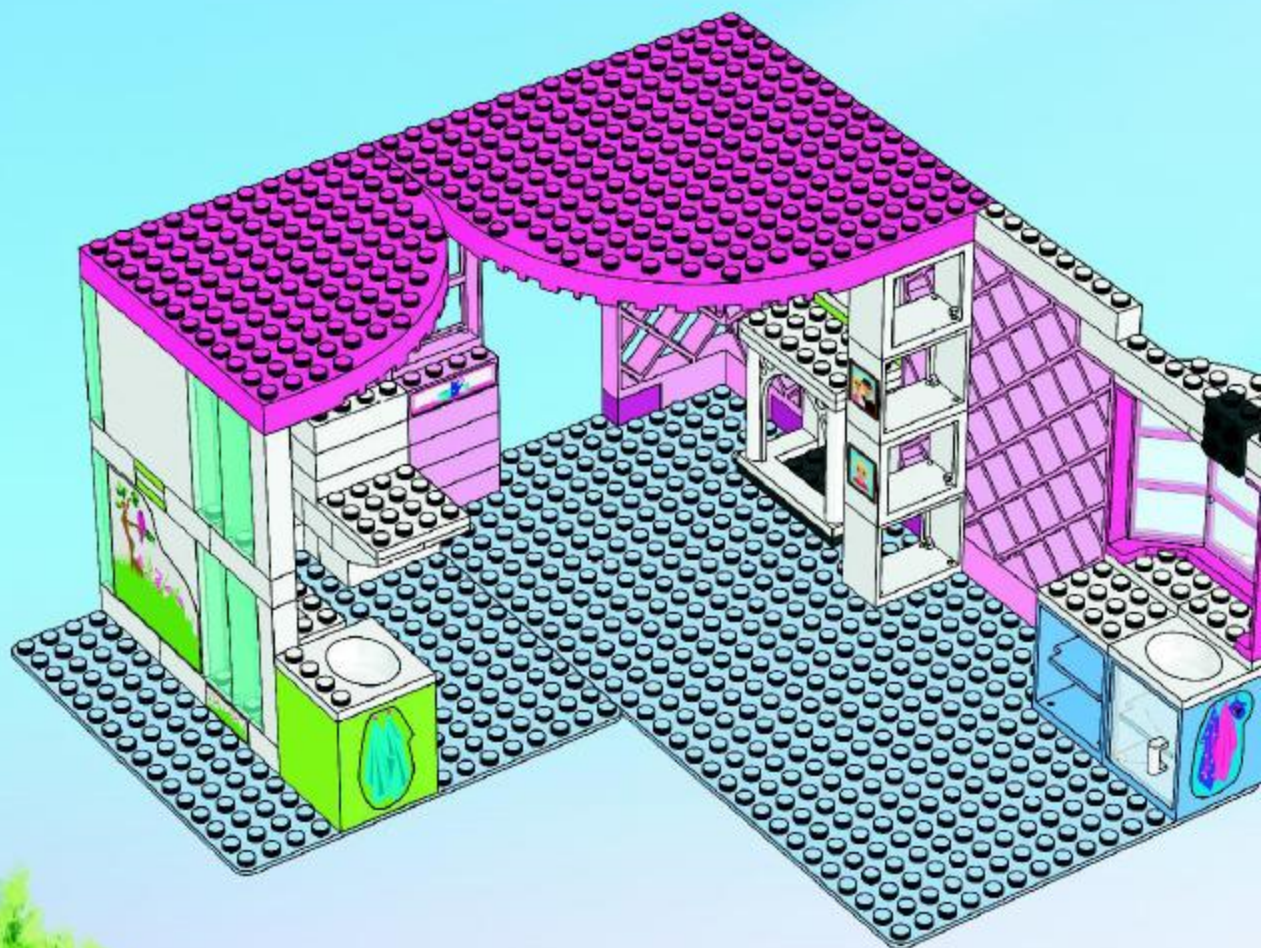

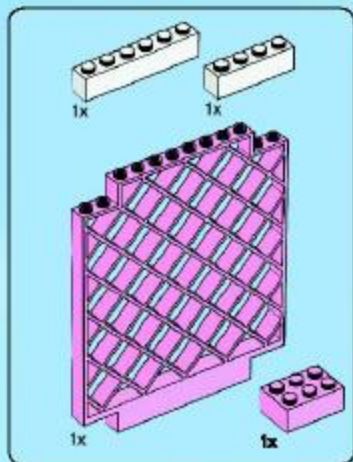

24

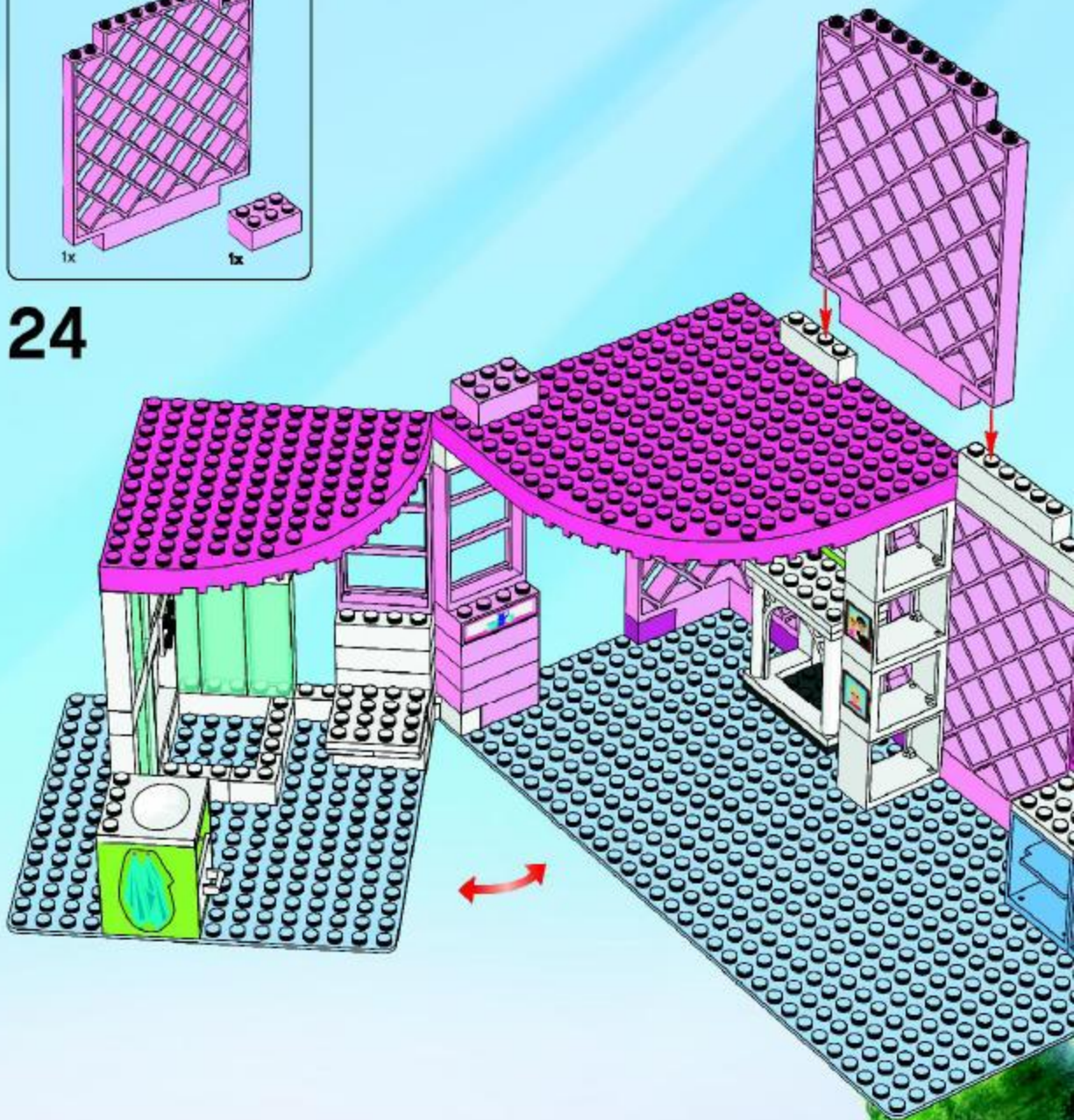

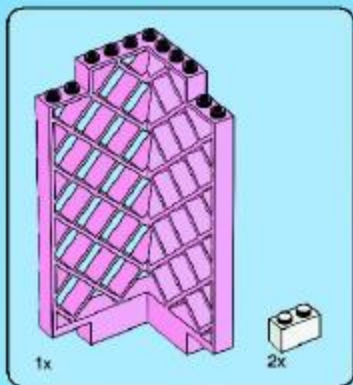

25

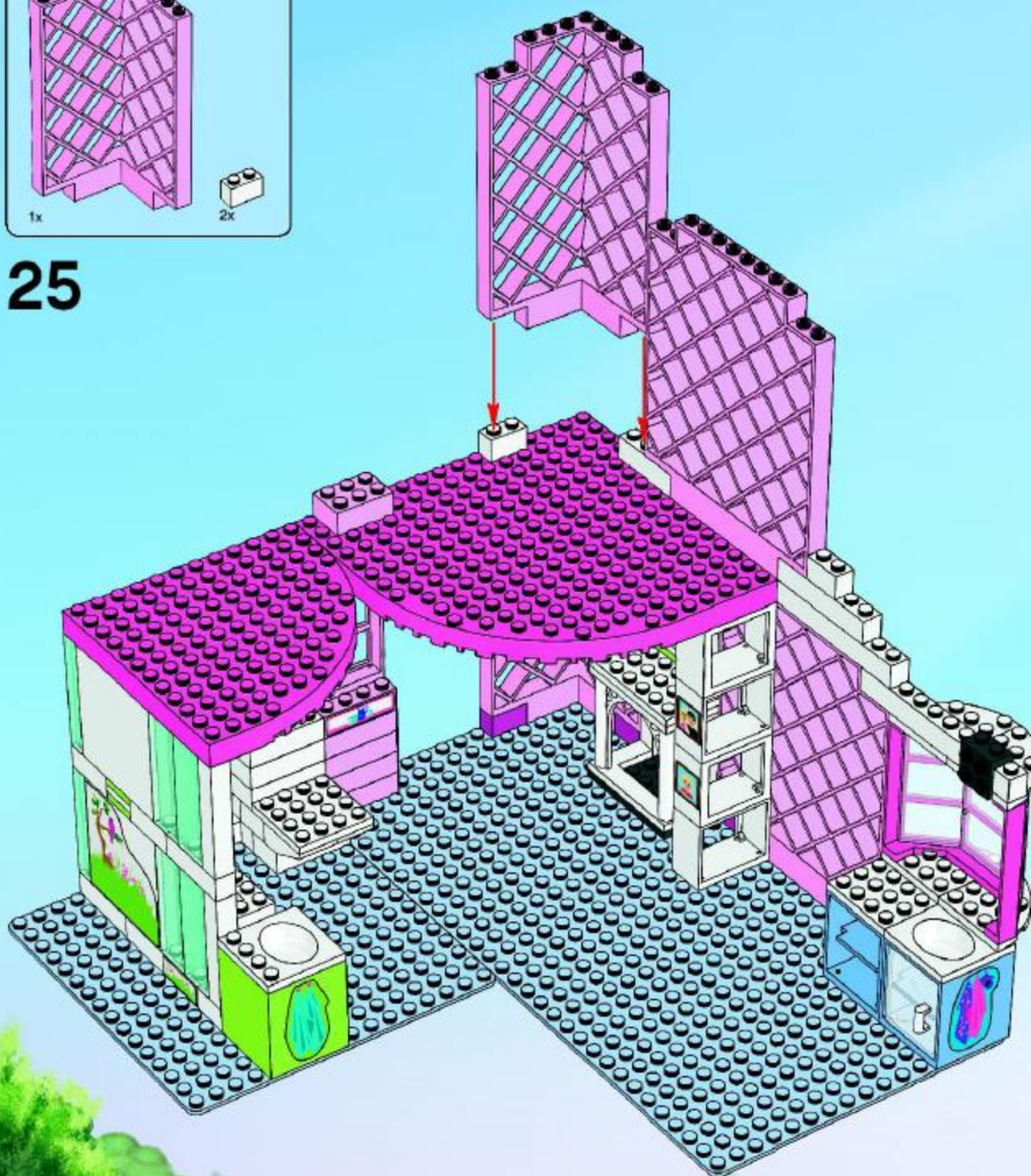



26

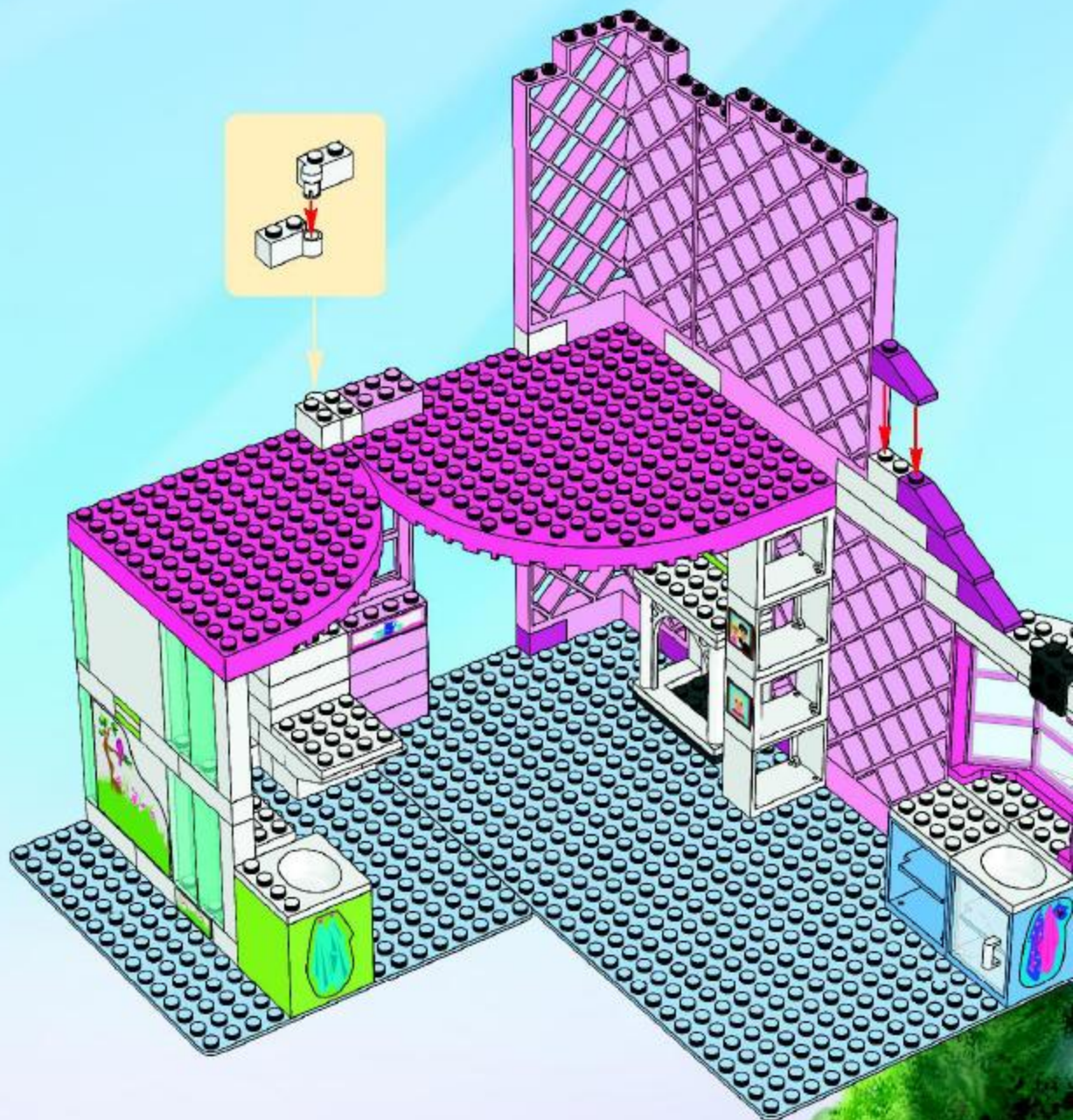
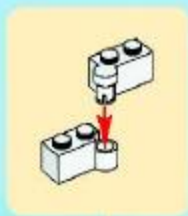

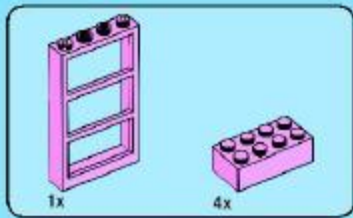

27

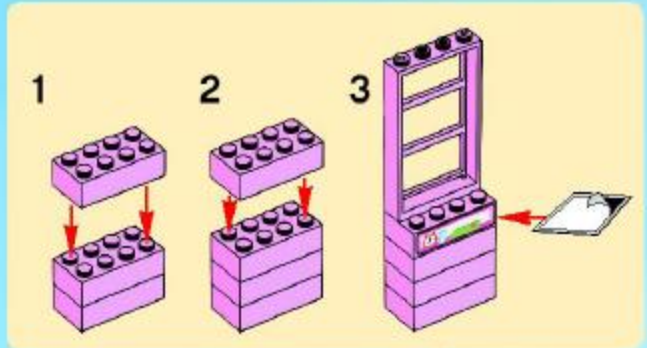

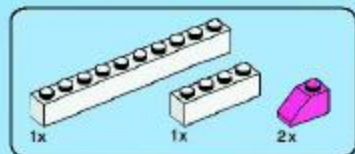

28

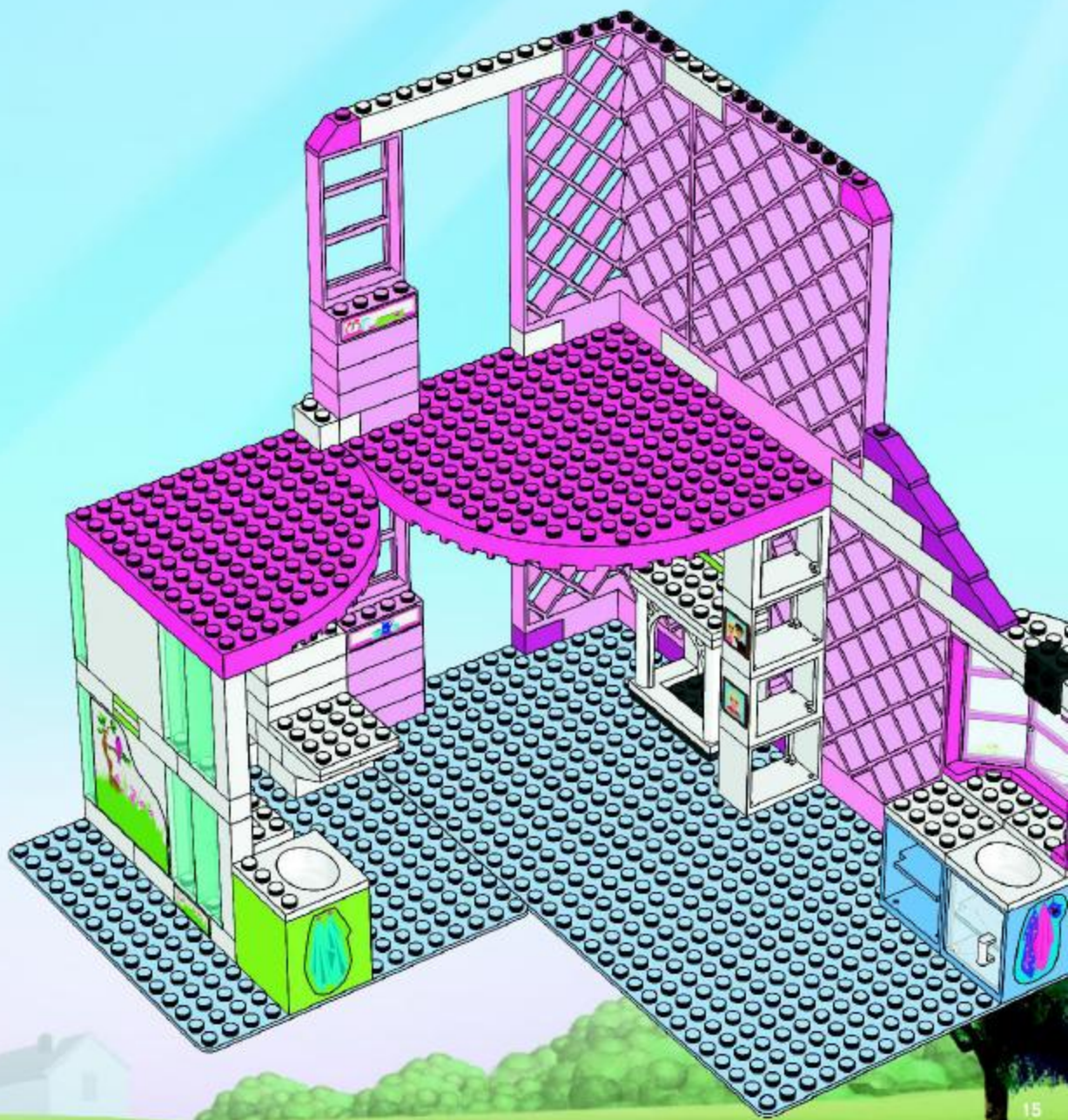

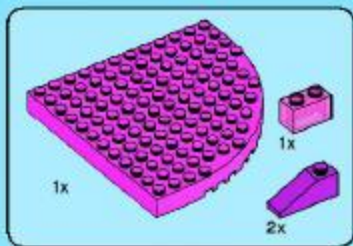

29

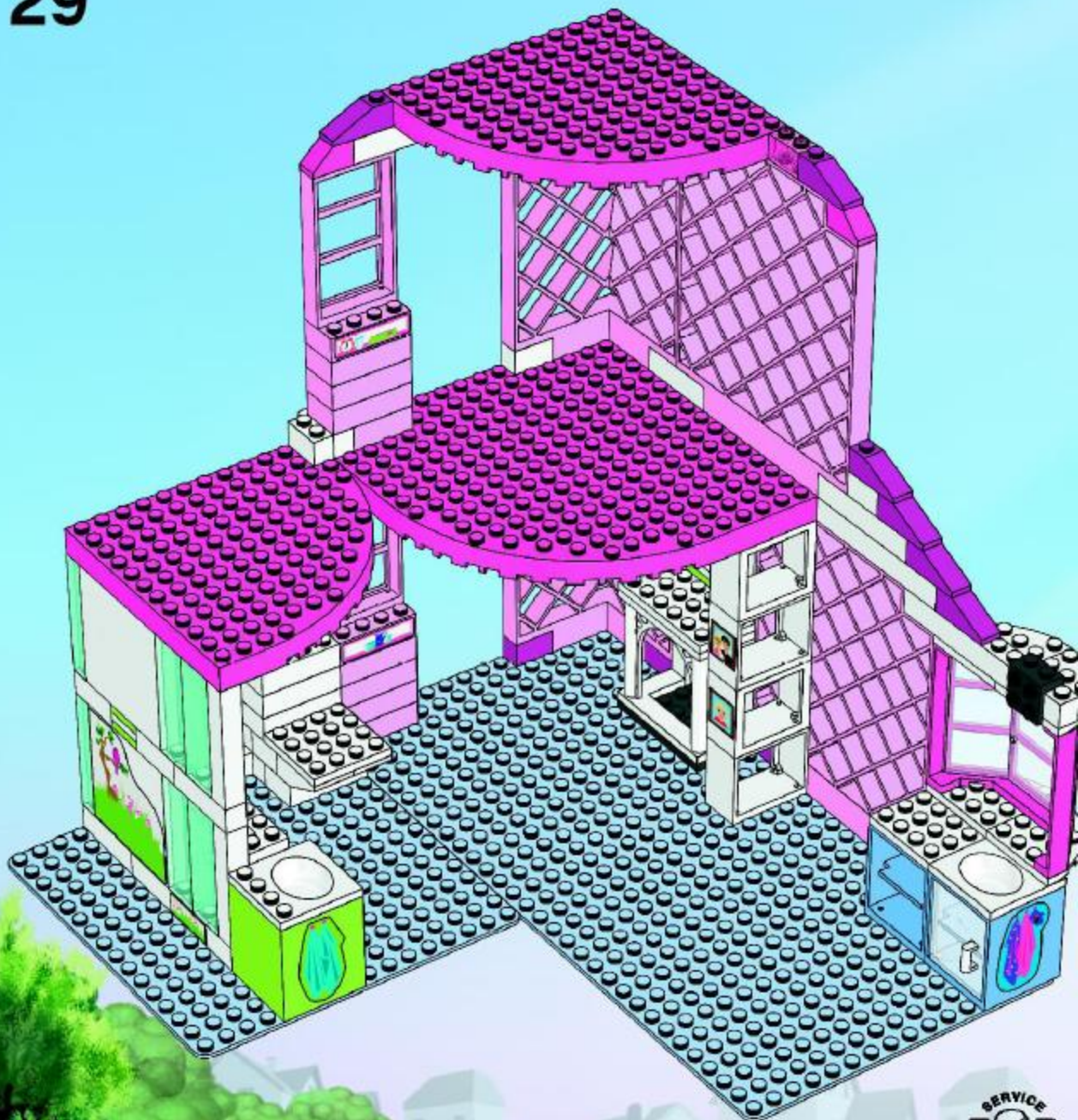



Belville™

7586

3/5



Lights up

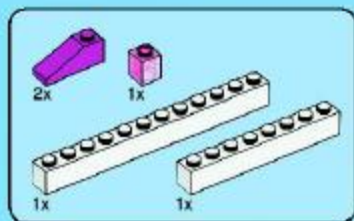

30



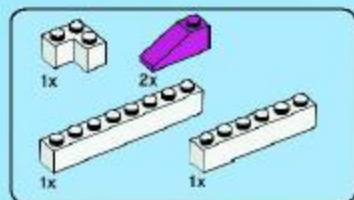

31

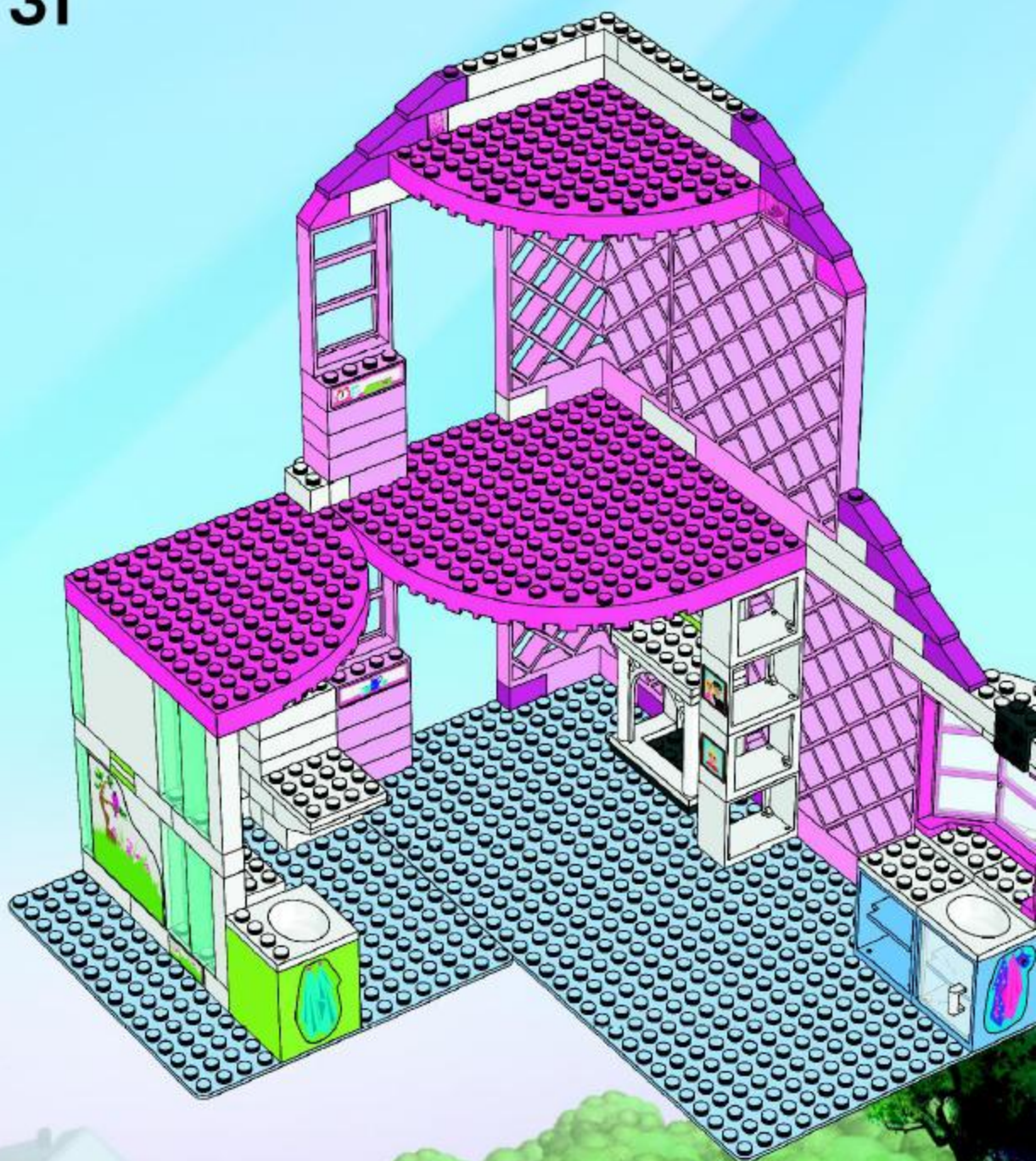

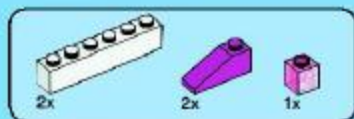

32



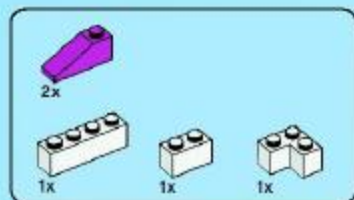

33

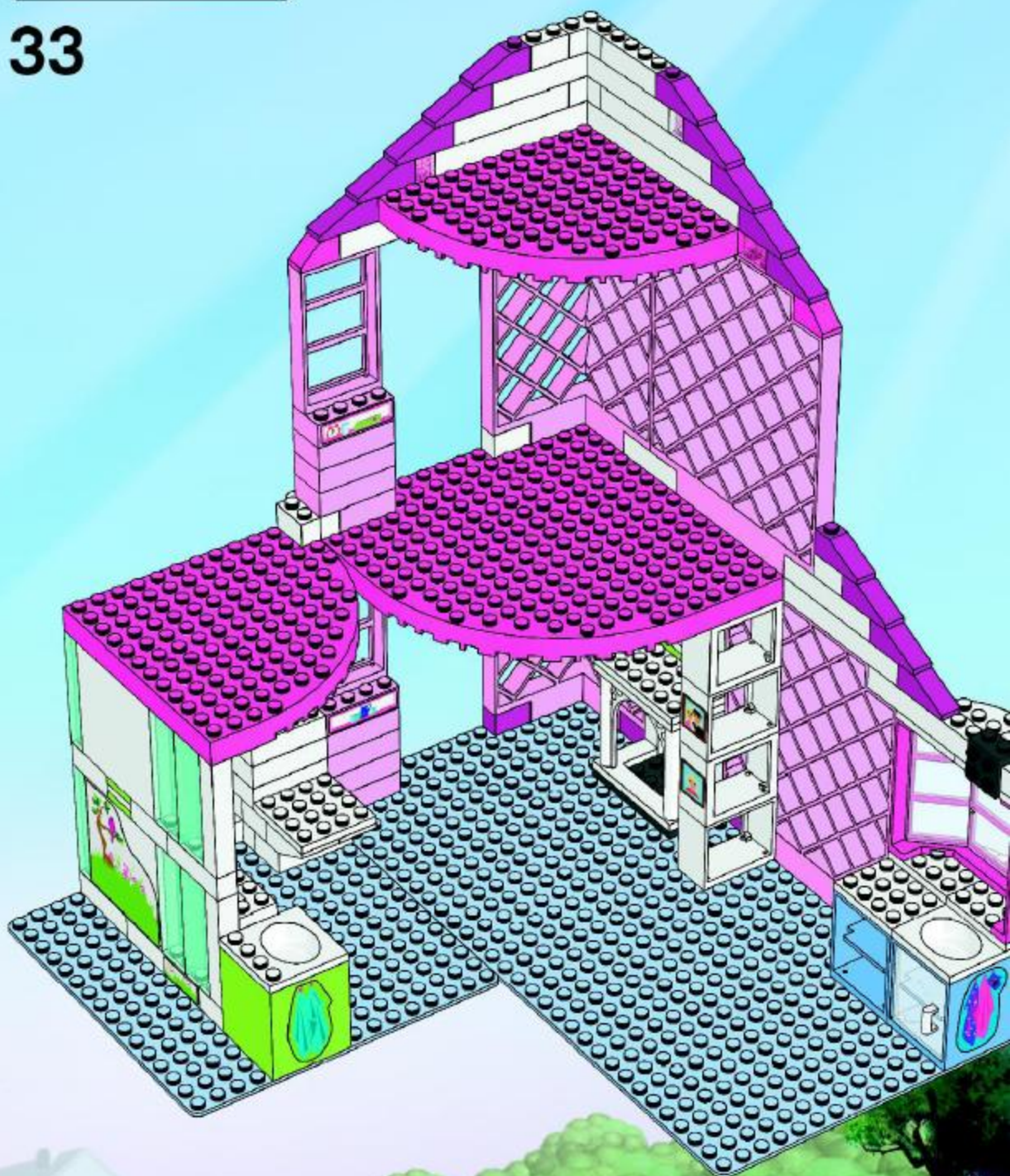



34



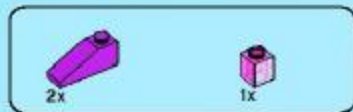

35

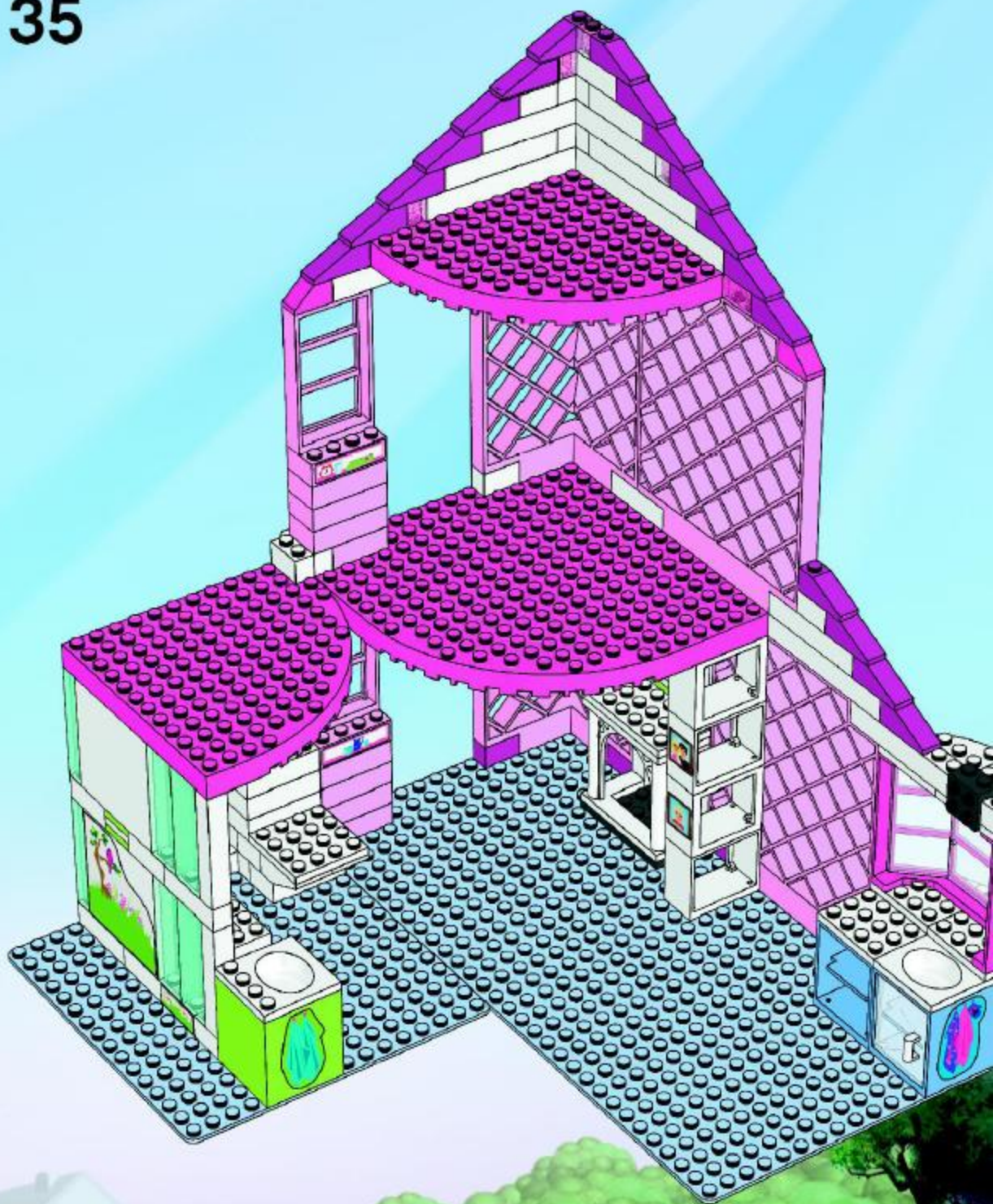

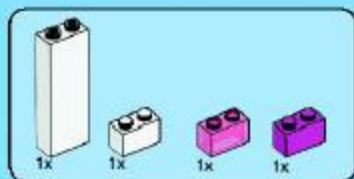

36

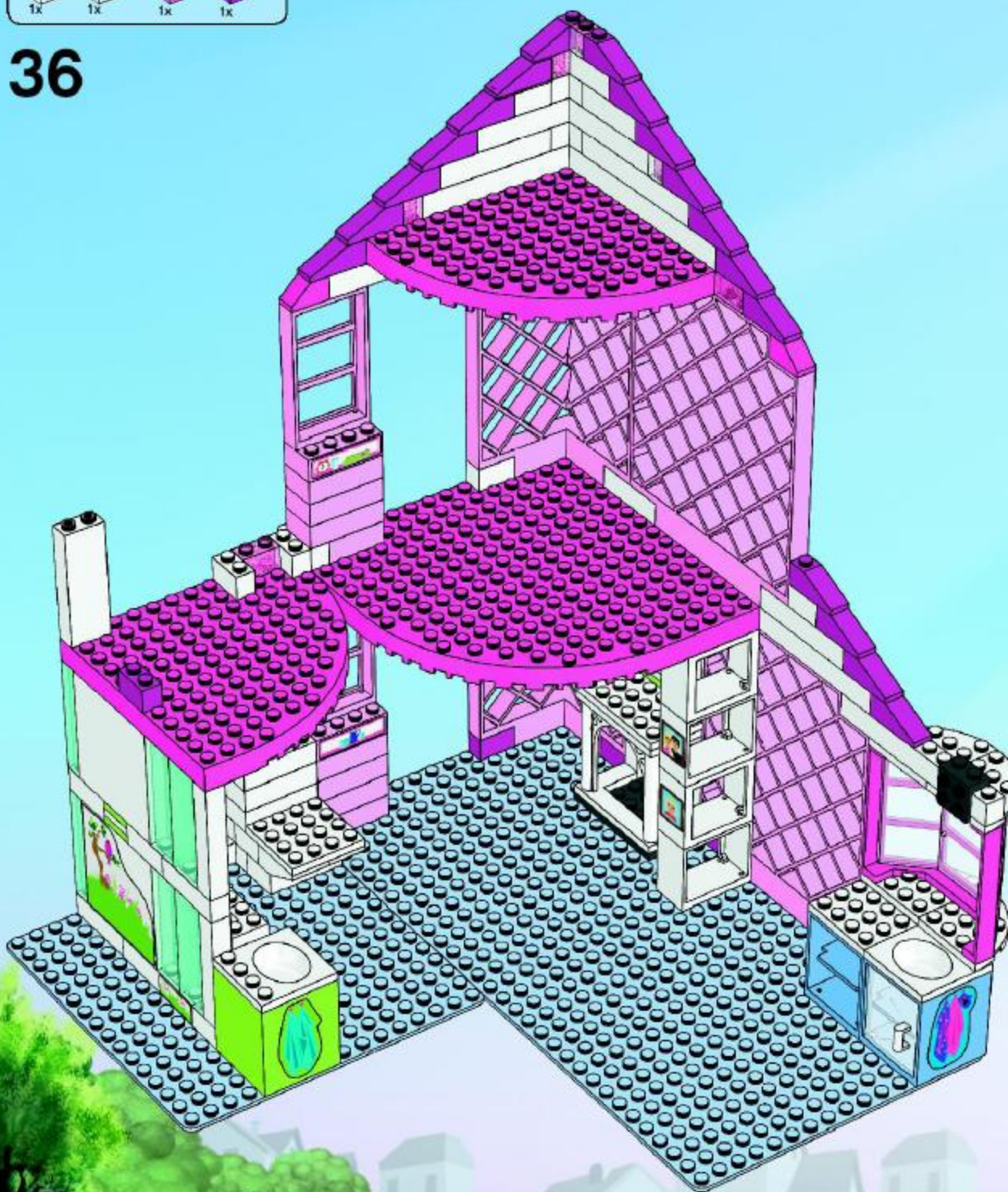

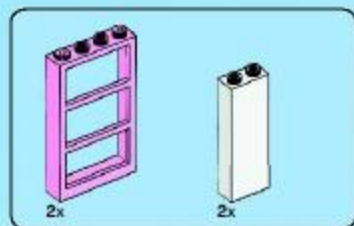

37

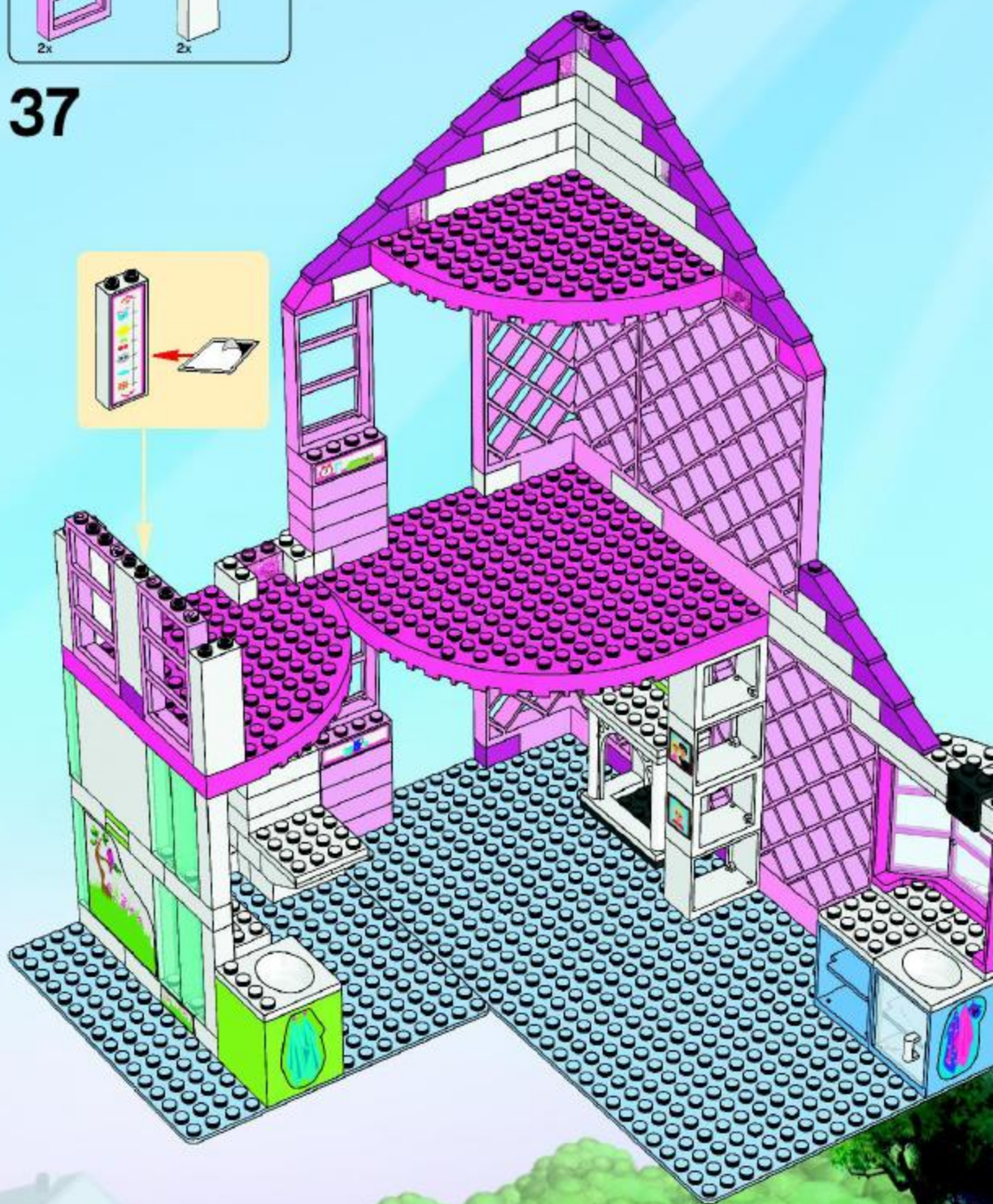



2x

38



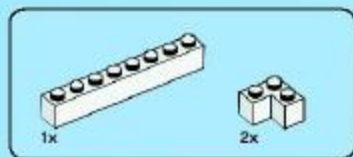

39

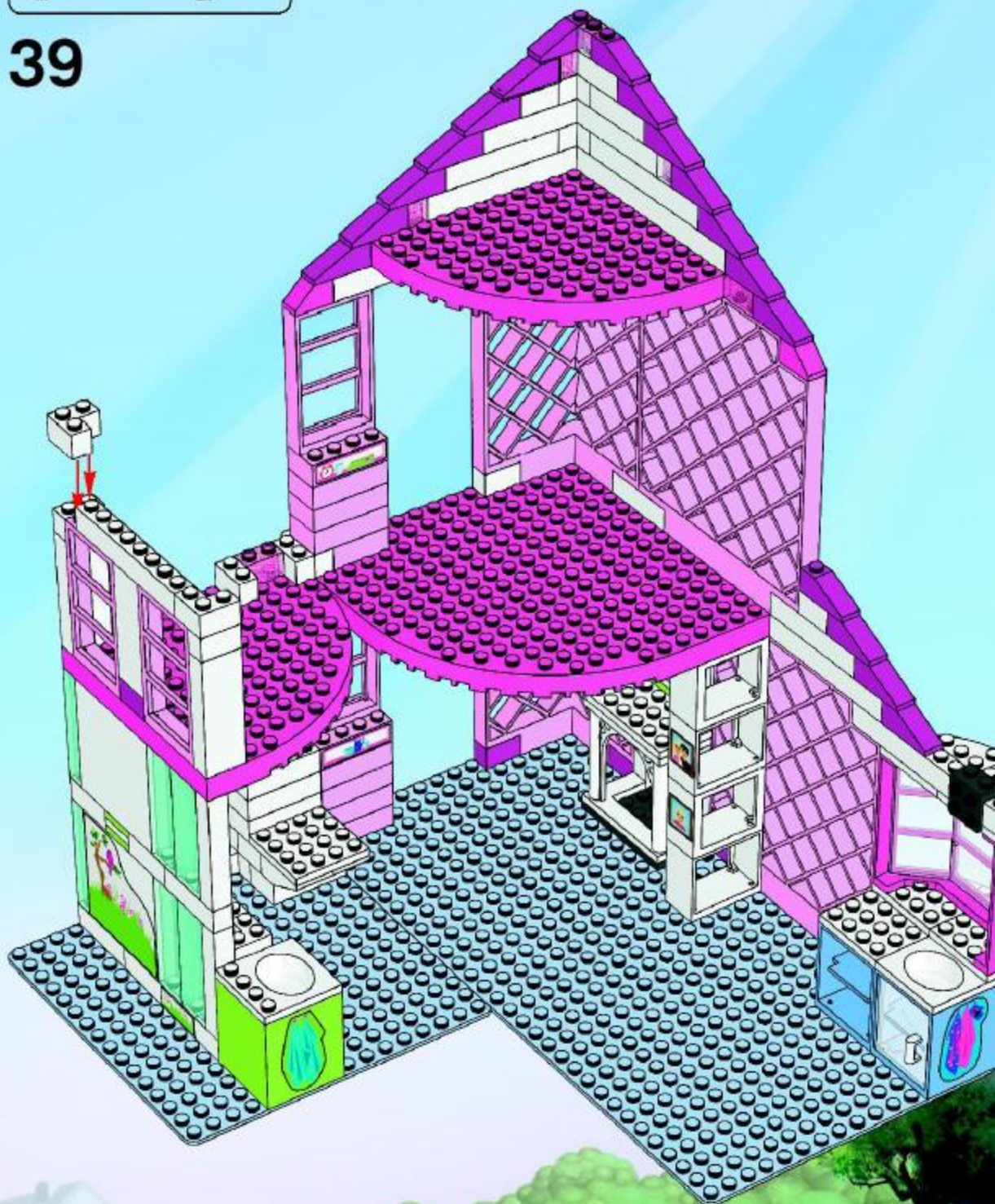

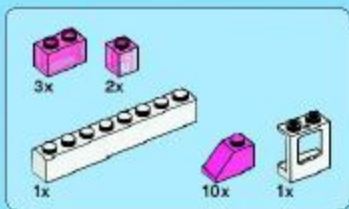

40

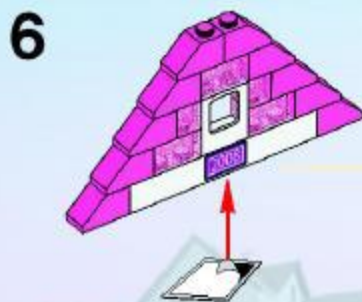
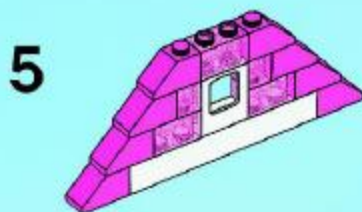
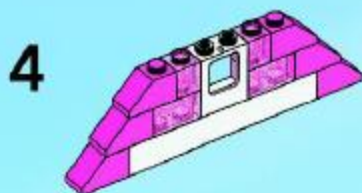
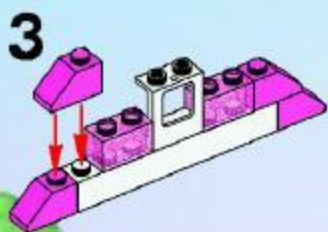
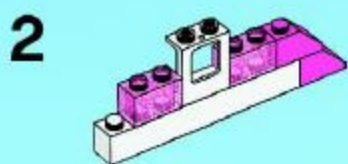

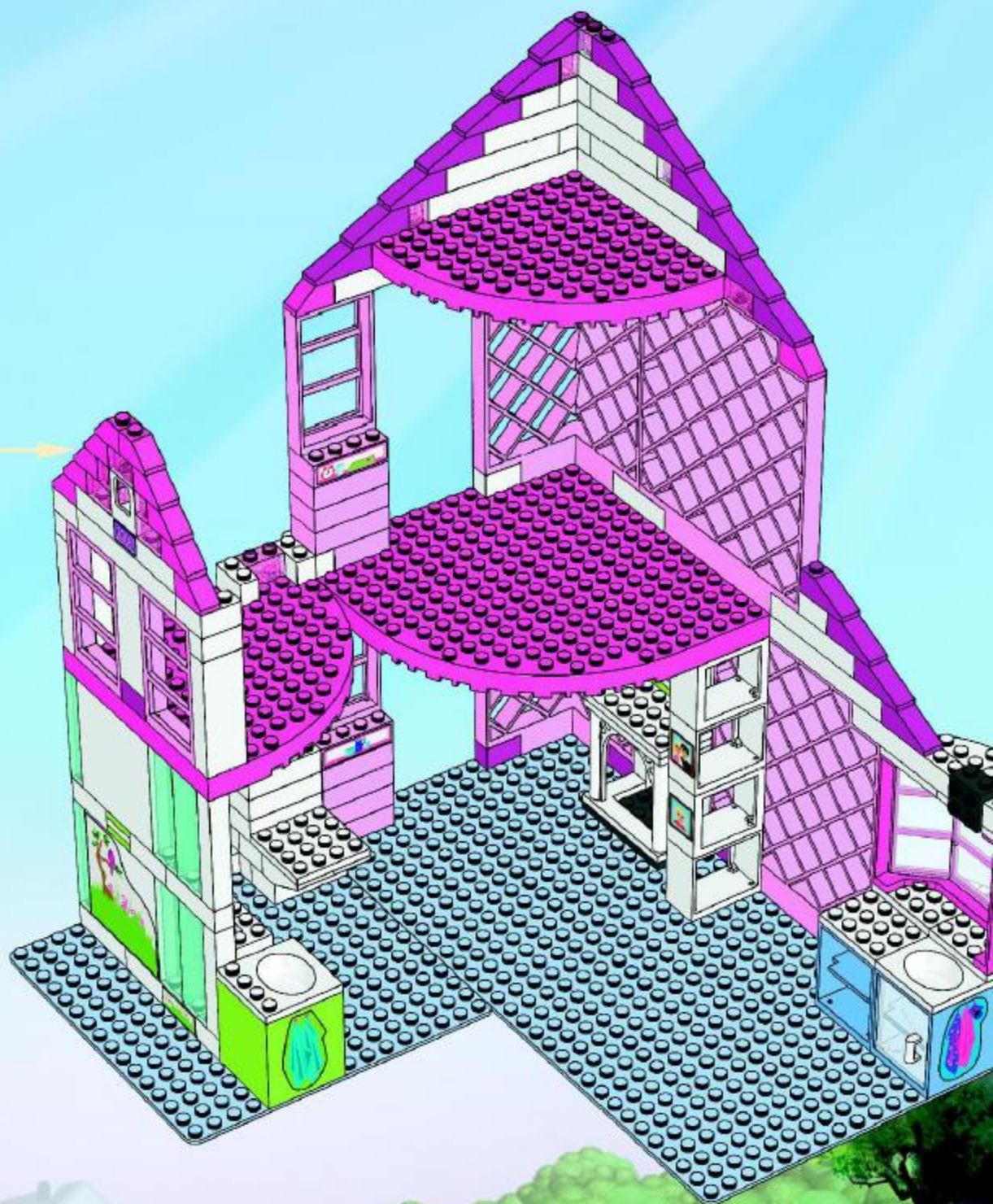

2



1x



2x



3x



1x



2x



2x

41

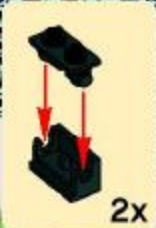

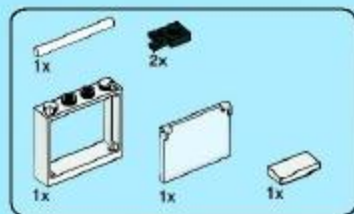

42

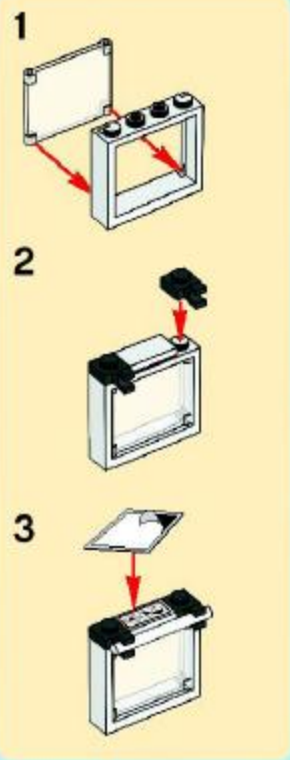

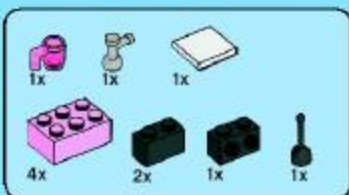

43

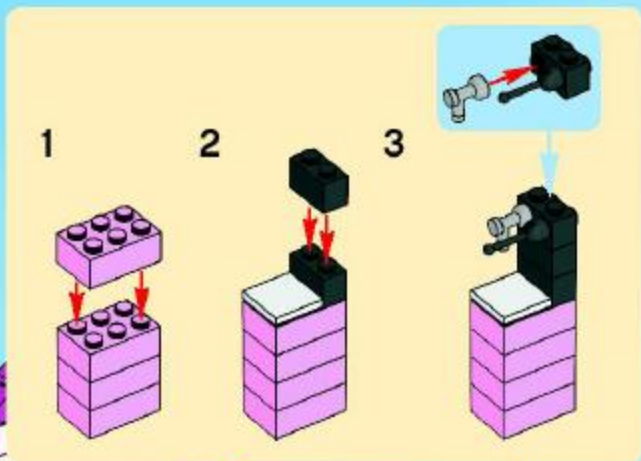



Belville™

7586

4/5



Lights up



44



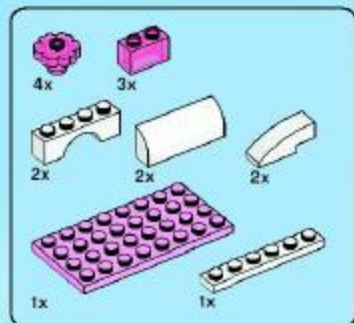

45

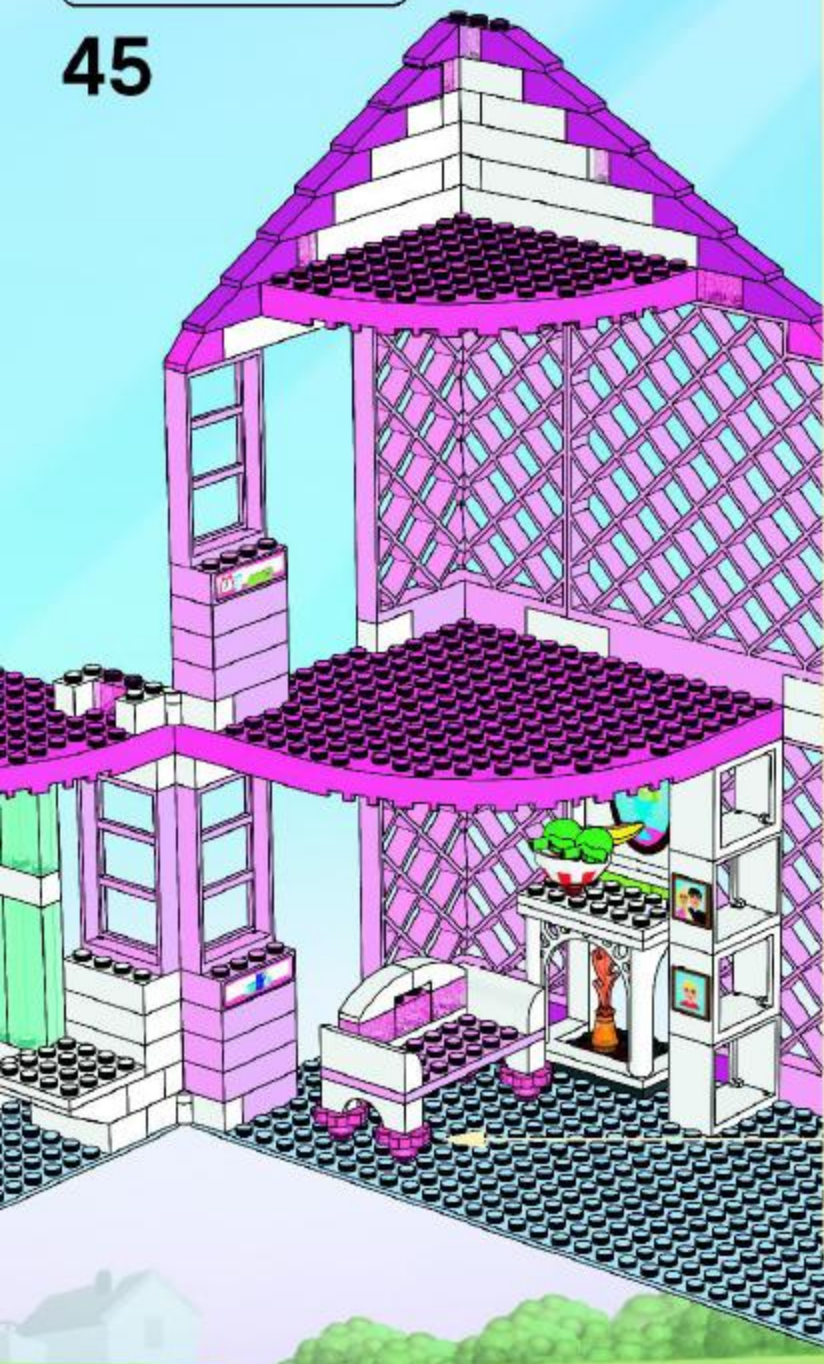

1

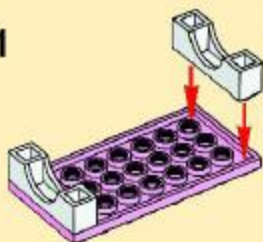

2

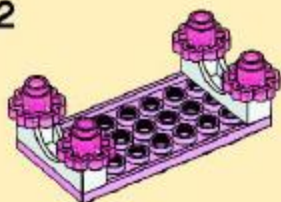

3



4



5

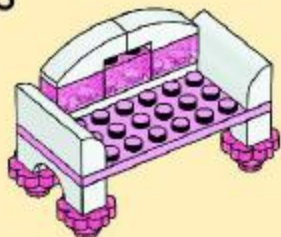

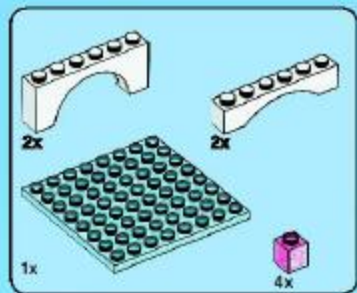

46

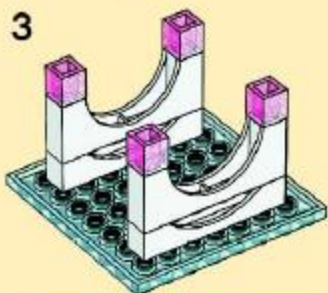
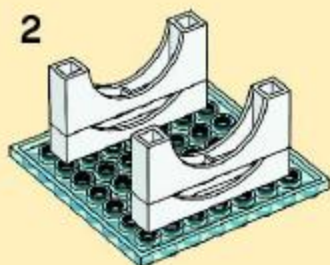
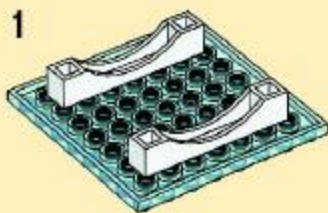

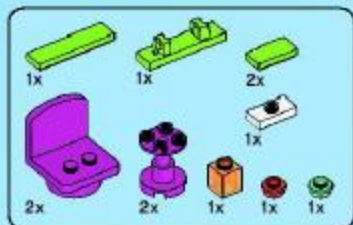

47

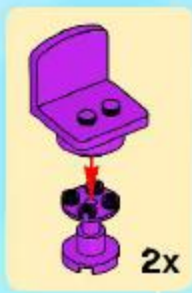



48





49





50

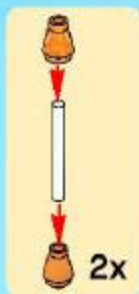



51

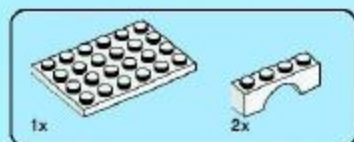

1

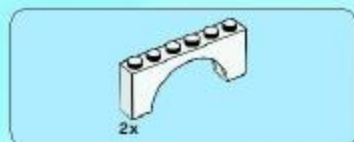
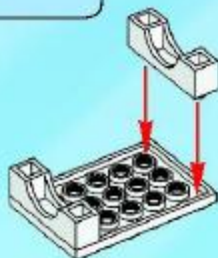

2

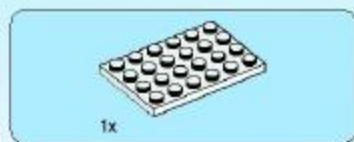
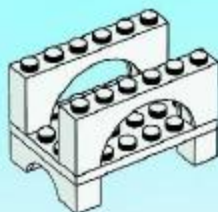

3



4



5



6





2x

7

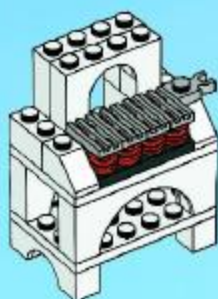

2x

8



2x



1x

9



2x



1x



1x



2x

10



1x



1x



1x

11

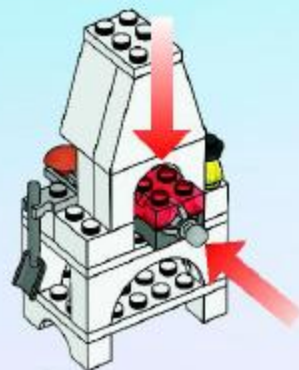

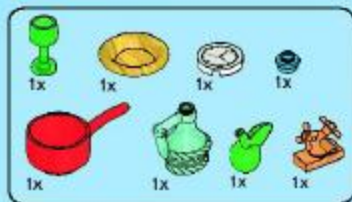

52

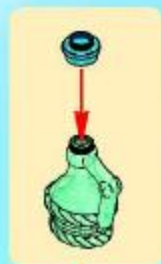



3

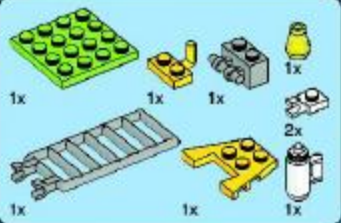

53

1



2



1



2



3



4



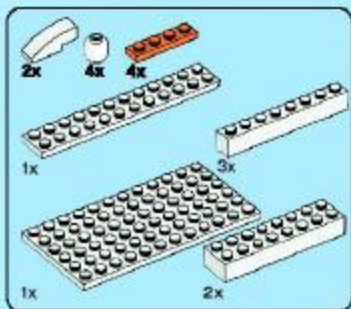
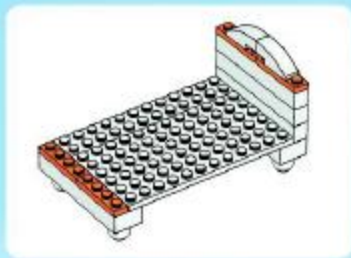

54

1

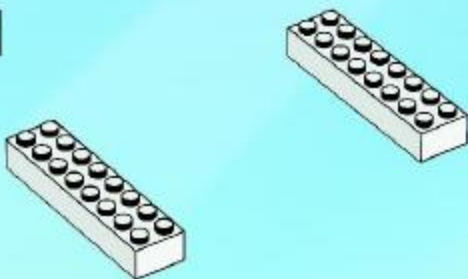

2

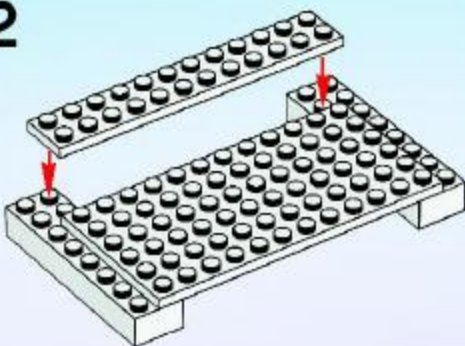

3

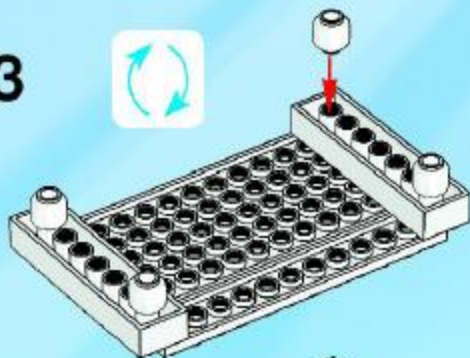

4

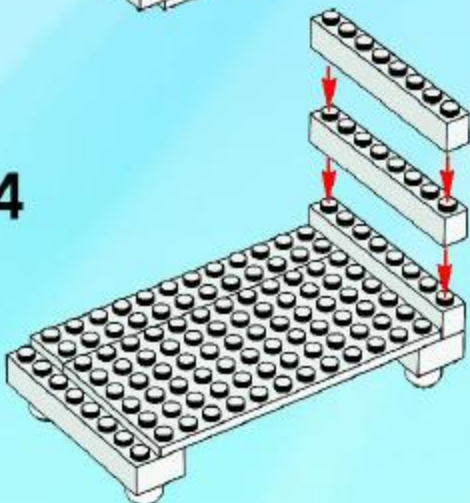

5

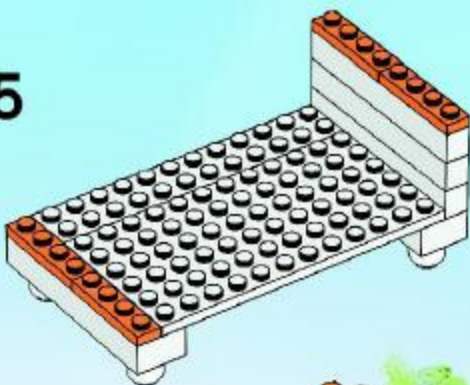

6

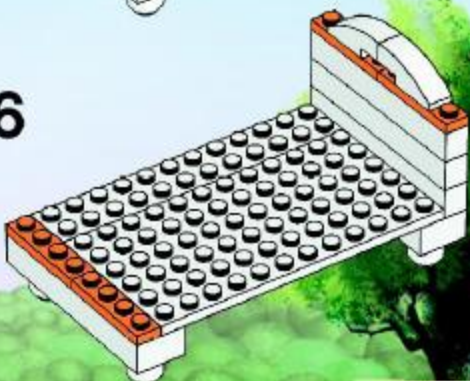



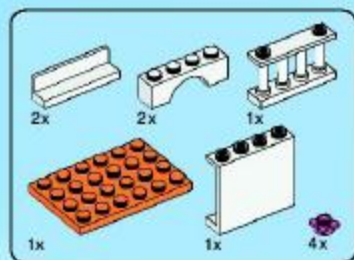

55

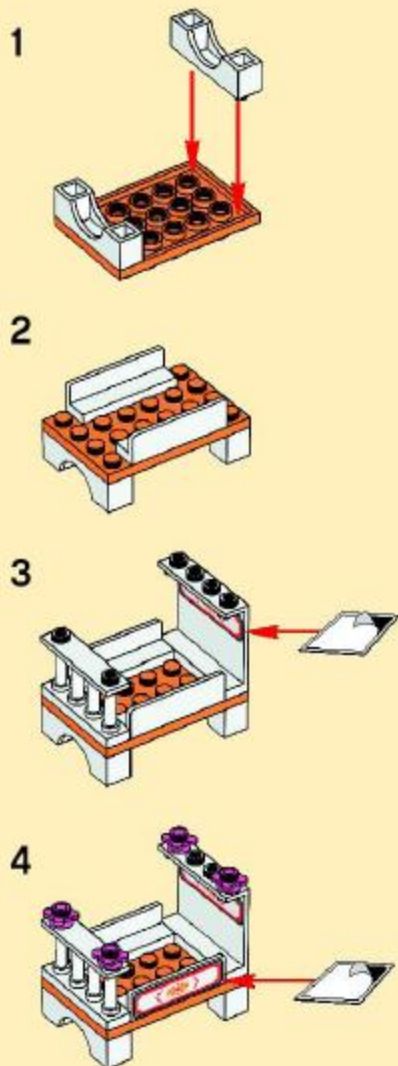



56

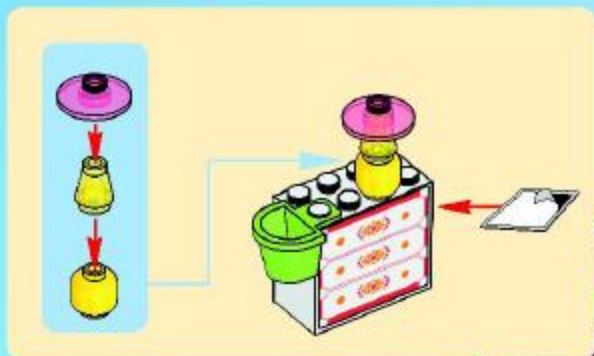



Belville™

7586

5/5



Lights up

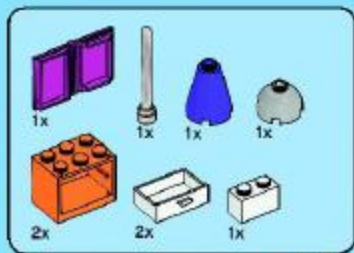

57



1



2



3

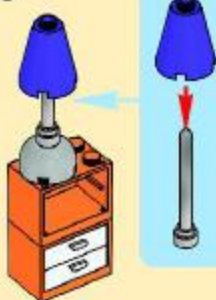

4

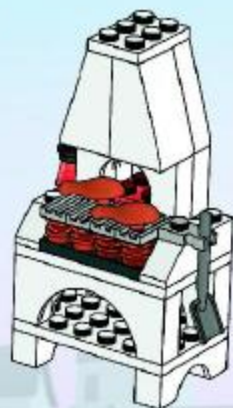
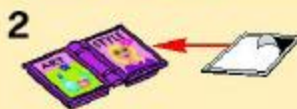
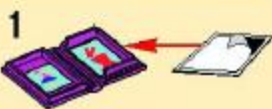
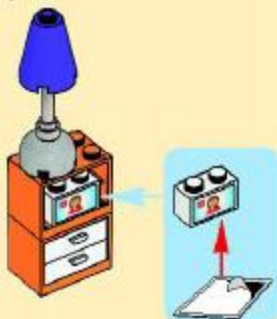

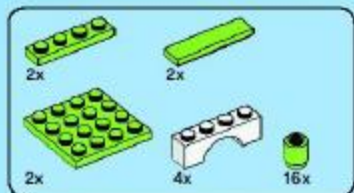

58

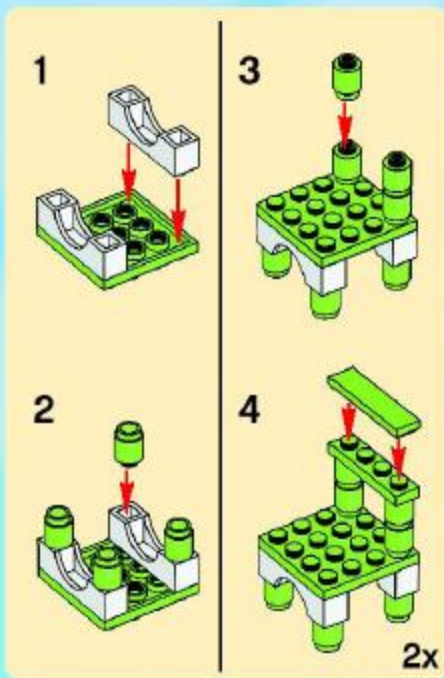



59

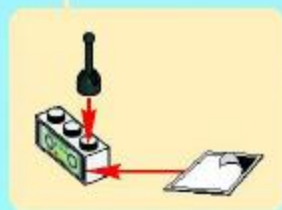
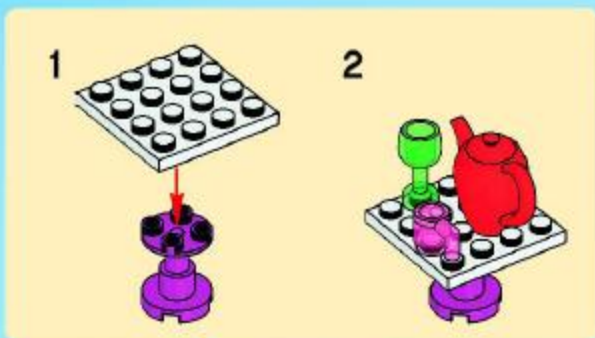

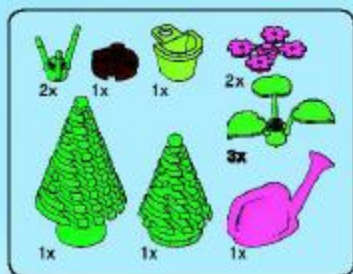

60

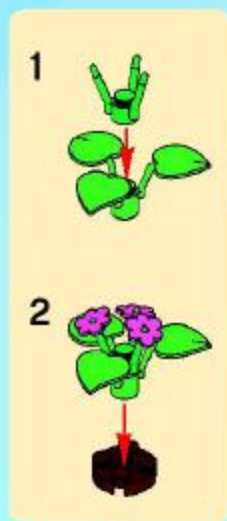
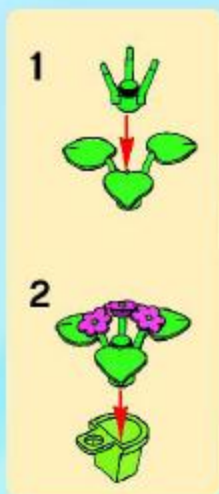

- 1x 4277920
- 2x 618201
- 2x 4189013
- 9x 300401
- 6x 362201
- 9x 301001
- 5x 300901
- 6x 300801
- 4x 611101
- 2x 611201
- 4x 245301
- 3x 245401
- 1x 4105202
- 3x 4504228
- 4x 4218839
- 4x 362601
- 2x 4297949
- 2x 4143976
- 2x 4500469
- 2x 300301
- 5x 300101
- 1x 4520983
- 2x 300701
- 5x 235701
- 10x 365901
- 2x 410141
- 4x 330701
- 4x 424912
- 2x 4520642
- 2x 4520636
- 1x 4520630
- 1x 4520674
- 1x 4283245
- 1x 4499698
- 1x 4593360
- 1x 300901
- 1x 306801
- 1x 4507355
- 1x 4520702
- 2x 383101
- 2x 383001
- 3x 4129836
- 1x 4261694
- 2x 4121932
- 2x 446001
- 2x 4173477
- 2x 601901
- 1x 4507685
- 1x 378401
- 1x 300601
- 1x 4499701
- 1x 302101
- 3x 4243912
- 4x 4178429
- 3x 303201
- 1x 244501
- 1x 4120020
- 1x 4243668
- 1x 4290324
- 1x 4219726
- 1x 421159
- 3x 4216591
- 2x 4273743
- 2x 4278013
- 2x 4520912
- 4x 418782
- 1x 4255308
- 1x 4499645
- 1x 4520656
- 2x 4520652
- 1x 4294909
- 1x 618941
- 3x 3005741
- 1x 612647
- 1x 3005747
- 2x 4520972
- 1x 4520636
- 3x 4119350
- 2x 3005743
- 2x 4520649
- 1x 4226439
- 1x 4520892
- 1x 4520893
- 10x 4282915
- 3x 4163917
- 1x 3000742
- 1x 4297454
- 1x 4501279
- 1x 4520666
- 2x 4521279
- 1x 4262656
- 5x 4221195
- 3x 4513239
- 1x 4284047
- 4x 4287800
- 1x 4277932
- 2x 300426
- 1x 4253815
- 2x 415026
- 2x 73587
- 2x 4517925
- 2x 393826
- 1x 302026
- 1x 303226
- 2x 393726
- 3x 614126



1x
4114584



1x
362624



1x
4240007



1x
4501109



4x
618944



2x
3005744



1x
347128



1x
243528



2x
374128



2x
4107050



3x
4107432



2x
4184851



1x
4520653



2x
4500125



3x
4164021



1x
4520811



2x
4520810



3x
4184037



3x
4167743



3x
4504850



18x
4212454



1x
4211375



1x
4211580



1x
4211637



1x
4279673



1x
4211470



4x
4211350



1x
4211503



1x
4211005



4x
4142894



2x
4216375



1x
4245167



2x
4243576



6x
4518892



6x
4520682



1x
4280173



4x
4143404



1x
4129859



14x
4216456



8x
4247094



1x
4243784



5x
4519195



2x
4520634



18x
4519196



3x
4243038



1x
4521205



4x
4216470



1x
4284508



1x
4459703



12x
4518891

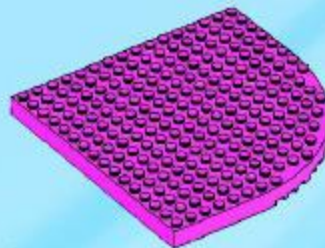

1x
4286793

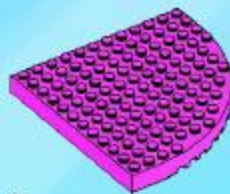

2x
4282776

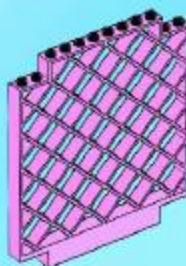

2x
4520539



2x
4519197



1x
4520813



6x
4520667



1x
4519435



1x
4518739



1x
4519434



1x
4518747



1x
4518742



1x
4500612



1x
4518746



1x
4518745



1x
4518745



GB
Important information about batteries
 Never use different types of batteries together, or a combination of old and new batteries. Always remove the batteries if the product is not to be used for a long time or if the batteries have run down. Never use damaged batteries. Only use batteries of the type recommended, or a corresponding type. Insert the batteries so that the poles are correctly positioned. Rechargeable batteries must be recharged using the correct battery charger under the supervision of an adult. You cannot recharge batteries while they are still in the product, and you must never try to do so. Never attempt to recharge non-rechargeable batteries. Never short-circuit the battery leads.

IT
Importanti informazioni sulle batterie
 Non usare mai contemporaneamente batterie di tipo diverso o batterie nuove e usate insieme. Rimuovere sempre le batterie quando il prodotto non venga utilizzato per periodi prolungati, oppure se le batterie sono esaurite. Non utilizzare mai batterie danneggiate. Usare solo esclusivamente batterie del tipo raccomandato o un equivalente. Inserire le batterie avendo cura che le loro polarità siano corrette. Le batterie ricaricabili vanno ricaricate in un caricabatterie di tipo idoneo e con la supervisione di un adulto. Non è possibile e non bisogna mai tentare di ricaricare le batterie mentre queste sono inserite nel prodotto. Non tentare mai di ricaricare le batterie non ricaricabili. Non cortocircuitare mai il pannello a

DK
Vigt information om batterier
 Brug aldrig forskellige typer batterier sammen, eller nye og gamle batterier samtidig. Tag altid batterierne ud, hvis du ikke skal bruge produktet i længere tid, eller hvis batterierne er brugt op. Anvend aldrig beskadigede batterier. Der må kun anvendes batterier af samme eller tilsvarende type som anbefales. Batterierne må kun sættes på, når de er korrekt. Genopladelige batterier skal oplades i en specielt beregnet oplader under opsyn af en voksen. Genopladelige batterier kan og må kun lades oplades i produktet. Forsøg aldrig at genlade ikke-genopladelige batterier. Korte-kvæb aldrig batterierne med hinanden.

DE
Wichtige Information zu Batterien
 Benutzen Sie niemals unterschiedliche Arten von Batterien oder alte und neue gleichzeitig. Nehmen Sie stets die Batterien heraus, wenn sich das Produkt längere Zeit nicht benutzen soll oder wenn die Batterien leer sind. Benutzen Sie niemals beschädigte Batterien. Verwenden Sie ausschließlich originale oder geeignete Batterien. Achten Sie beim Einsetzen der Batterien auf die richtige Polung. Wiederaufladbare Batterien sollten nur einem geeigneten Ladegerät aufgeladen werden – unter der Aufsicht eines Erwachsenen. Batterie können und sollen ebenfalls aufgeladen werden, während sie sich im Produkt befinden. Versuchen Sie unter keinen Umständen, „normale“ Batterien wiederaufladbar zu machen. Schließen Sie die Batterien nicht miteinander kurz.

NL
Belangrijke informatie over batterijen
 Gebruik nooit verschillende soorten of nieuwe en oude batterijen tegelijkertijd. Verwijder de batterijen altijd als u het product lange tijd niet wilt gebruiken of als de batterijen leeg zijn. Nooit beschadigde batterijen gebruiken. Uitsluitend batterijen van het aanbevolen of overeenkomstige type gebruiken. Let de batterijen even de polen in de juiste richting. Opladbare batterijen moeten in een voor dit doel bestemde oplader en onder toezicht van een volwassene opgeladen worden. Opladbare batterijen kunnen en mogen ook worden opgeladen in het product. Probeer nooit niet-oplaadbare batterijen op te laden. Nooit de batterijen met elkaar kortsluiten.

FI
Tärkeää tietoa paristoista
 Älä laadaa yhtäi erityyppisiä paristoja yhtäaikaan. Älä yhdistä vanhoja paristoja uusien paristojen kanssa. Poista paristot tuotasta aina, kun se ei pidennetä aikaa käyttöösi tai kun paristot ovat tyhjiä. Älä laadaa vaurioituneita paristoja. Käytä vain tuotteen tai ohjeiden tai valmistajayhteyden paristoja. Ainoa paristot, jotka voit laadata tuotteeseen, on laadunvarmistetut, jotka voit laadata tuotteen sisällä. Älä laadaa paristoja, jotka eivät ole tarkoitettu latautumaan. Älä yritä laadata uudelleen paristoja, jotka eivät ole tarkoitettu uudelleen käyttöön.

FR
Informations importantes concernant les piles
 Ne jamais utiliser un mélange de différents types de piles, ou de piles neuves et de piles usées ou défectueuses. Toujours retirer les piles si le produit n'est pas utilisé durant une période prolongée ou si les piles sont vides. Ne jamais utiliser de piles endommagées. Utiliser uniquement des piles du type recommandé ou d'un type équivalent. Insérer les piles, respecter scrupuleusement le sens d'insertion des piles (+/-). Les piles rechargeables doivent être rechargées en utilisant un chargeur de piles adapté et sous la surveillance d'un adulte. Il est impossible de recharger les piles quand elles sont insérées dans le produit. Ne jamais tenter de recharger les piles non-rechargeables. Ne jamais court-circuiter le compartiment des piles.

ES
Importante información sobre las baterías
 No mezclar nunca diferentes tipos de baterías, ni utilizar baterías antiguas y nuevas o si las baterías antiguas son defectuosas. Siempre retirar las baterías si el producto no se usará por un largo período de tiempo o si las baterías están descargadas. No utilizar nunca baterías dañadas. Utilizar solo el tipo de baterías recomendadas o una correspondiente. Colocar las baterías de manera que los polos estén en su posición correcta. Las baterías recargables deben cargarse con un cargador adecuado bajo la supervisión de un adulto. Las baterías no pueden ni deben cargarse mientras permanecen en el producto. No intentar nunca recargar las pilas no recargables. Advertencia que no se debe intentar es cortocircuitar el polo batería.

SE
Viktig information om batterier
 Använd aldrig olika sorters batterier samtidigt, och inte heller en kombination av gamla och nya batterier. Ta alltid ur batterierna om produktens användning ska vara ett tag eller om batterierna är utslutna. Använd aldrig skadade batterier. Använd bara batterier av den typ som rekommenderas, eller av en motsvarande typ. Sätt i batterierna så att polerna ligger i rätt Rikt. Laddningsbara batterier måste laddas med rätt typ av laddningsutrustning och under en vuxens övervakning. Du kan ladda laddbara batterier medan de fortfarande sitter i produktens, och du får heller aldrig försöka ladda icke-laddningsbara batterier. Kortslut aldrig helt enkelt laddningsbara batterier. Kortslut aldrig batterierna med varandra.

- EN Protect the environment by not disposing of this product with your household waste (2002/96/EC). Check with your local authority for recycling advice and facilities.
- DE Schützen Sie die Umwelt und entsorgen Sie dieses Produkt nicht mit Ihrem Hausmüll (2002/96/EC). Informationen zu Recycling-Möglichkeiten erhalten Sie bei den örtlichen Behörden.
- FR Protégez l'environnement : ne jetez pas ce produit avec vos autres déchets ménagers (Directive européenne 2002/96/EC). Contactez les autorités locales pour obtenir des informations sur le recyclage et connaître les points de collecte.
- IT Proteggi l'ambiente! Non ammettere questo prodotto con i rifiuti domestici (2002/96/EC). Per consulenza sul riciclaggio dei rifiuti e le strutture di riciclaggio, rivolgerti alle proprie autorità locali.
- NL Bescherm het milieu: gooi dit product niet samen met het andere huisvuil weg (2002/96/EC). Raadpleeg de plaatselijke instanties voor locaties van milieustations en advies over hergebruik.
- ES Proteja el medio ambiente no deshaciéndose de este producto junto con sus residuos domésticos (2002/96/EC). Solicite a su autoridad local consejos e información sobre instalaciones de reciclado.
- DA Bækkyt miljøet! Smid ikke dette produkt ud sammen med husholdningsaffaldet (2002/96/EF). Få vejledning om genbrug og genbrugsstationer hos din kommune.
- FI Tämä tuote on hävitettävä ympäristönsuojelun vuoksi asienmukaisesti talousjätteilistään erillisin (2002/96/EC). Tietoja kierrätyspisteiden sijainnista saa kunnan tai kaupungin teknisestä virastoista.
- SV Skydda miljön genom att inte kasta denna produkt bland ditt hushållsavfall (2002/96/EC). Kontakta din kommun för frågor om återvinning och miljöstationer.
- PT Proteja o ambiente não eliminando este produto com o seu lixo doméstico (2002/96/CE). Consulte as autoridades locais para informação sobre reciclagem e sistemas de recolha.
- EL Προστατέψτε το περιβάλλον. Μην πετάτε αυτό το προϊόν μαζί με τα συνήθιστα οικιακά απορρίμματα (2002/96/EC). Επικοινωνήστε με τις τοπικές αρχές σχετικά με συμβουλές και εγκαταστάσεις ανακύκλωσης.
- PL Aby chronić środowisko naturalne, nie należy wyrzucać tego produktu wraz z odpadkami z gospodarstwa domowego (2002/96/WE). W celu uzyskania wskazówek dotyczących recyklingu oraz adresów zakładów należy skontaktować się z lokalnym urzędem.
- CS Nevyhazujte tento produkt do domácího odpadu, chraňte životní prostředí (2002/96/EC). Zjistěte si prosím u místních úřadů možnosti recyklace a dostupná zařízení.
- SK Nevyhadzujte tento produkt do domáceho odpadu, chráňte životné prostredie (2002/96/EC). Zistite si prosím na miestnych úradoch možnosti recyklácie a dostupné zariadenia.
- HU Környezetét óvja, ha eztől a termékétől nem a háztartási hulladékkal együtt válik meg (2002/96/EC). Érdeklődjék a lakóhelyéhez közel eső hatóságnál az újrahasznosítás módjáról és lehetőségeiről.
- SL Zaščitite okolje! Okolje varujte tako, da tega izdelka ne zavržete skupaj z gospodinjskimi odpadki (v skladu z direktivo 2002/96/ES). Pri krajevni upravi preverite, kakšne možnosti in kateri obrati za recikliranje obstajajo v vaši okolici.
- LV Lai saudzētu vidi, nelietmet šo izstrādājumu kopā ar sadzīves atkritumiem (2002/96/EC). Vērsieties vietējs varas iestādēs, lai noskaidrotu, kur un kā tas nododams pārstrādāt.
- ET Keskkonda saate kaitsta nii, et ei kõrvalda seda toodet koos omeijätmetega (2002/96/EÜ). Nõuandeid toote taaskasutusse võtmise ja ümbertöötlemispunktide kohta saate asjaomastelt kohalikest asutustelt.
- LT Saugykite aplinką – nemeskite šio produkto kartu su buitinėmis atliekomis (2002/96/EB). Atsivaidite į savo vietos valdžios rekomendacijas dėl pakartotinio panaudojimo ir sąlygas.



Belville™

Belville.LEGO.com

LOTS OF FUN AND PLAY

Jede Menge Spielspaß
Des heures de jeu et d'amusement
Montones de diversión y juego
Muito divertimento e brincadeira
Sok-sok játék és vidámság
楽しく遊ぶ



WWW.LEGOSHOP.COM



 www.LEGO.com

7583



7585



7586



7587







Lights up

- Lights up
- Leuchtet auf
- Allume la torche
- Con Luz
- Acende
- Lámpát bekapcsolni





WIN LEGO® PRODUCTS

No purchase necessary.
Open to residents of all countries where
not prohibited.
Go to www. for official rules and details.

WIN LEGO® PRODUCTEN

Kopen niet nodig.
Open voor alle leeftijden, en in alle landen
waar geen verbod geldt.
Ga naar www. voor officiële regels en details.

GEWINNE LEGO® PRODUKTE

Die Teilnahme am Gewinnspiel führt zu
keinerlei Kaufverpflichtungen.
Sie können in allen nicht ausgeschlossenen
Ländern teilnehmen.
Die offiziellen Regeln und nähere Informationen
finden Sie unter www.

GAGNE DES PRODUITS LEGO®

Aucun achat n'est nécessaire.
Ouvert à tous les âges et aux résidents de
tous les pays, sauf en cas d'interdiction.
Rendez-vous sur www. pour obtenir plus
de détails et le règlement officiel.

レゴ®製品を「当てよう」

購入は不要です
禁止されていない限り、あらゆる
年代およびあらゆる国の居住者の
方々にご利用いただけます。
公認規則および詳細につきましては、
www.をご覧ください



WIN
WIN
GEWINNE
GAGNE
「当てよう」

